

**KEEP FOR FUTURE REFERENCE**



*P.O. Box 368 – 908 West Main  
Laurel, MT USA 59044  
phone 800-548-7341  
phone 406-628-8231  
fax 406-628-8354*

# INSTRUCTIONS

International Version

STOCK NUMBER: 95902

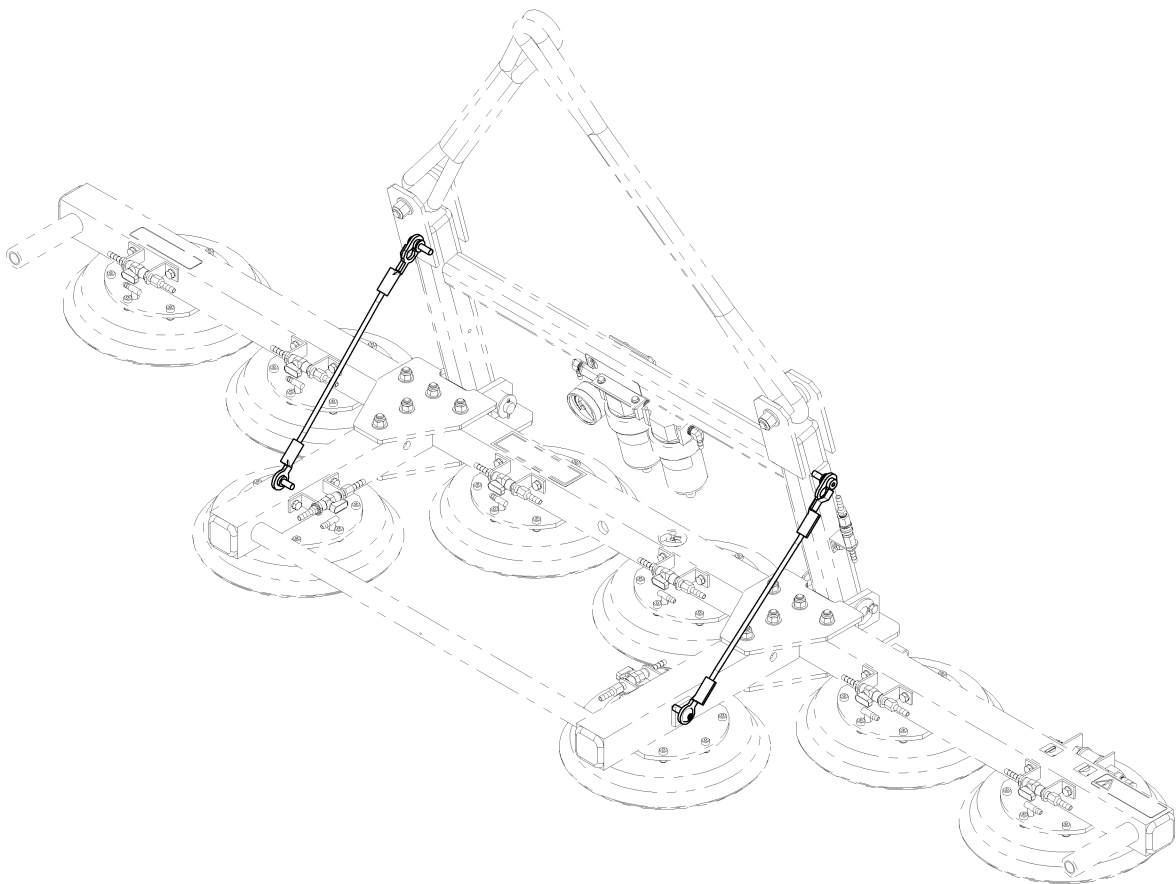

## MT SERIES FLAT LIFT ADAPTER



***READ ALL INSTRUCTIONS AND WARNINGS  
BEFORE USING THIS PRODUCT***



**DESIGNED FOR THE MATERIALS HANDLING PROFESSIONAL**



# SPECIFICATIONS

---

**Stock Number:** 95902

**Description:** This option allows a Wood's Powr-Grip MT-HV11F Series vacuum lifter to lift loads encountered in the flat position, by securing the pad frame in a horizontal orientation.

**Weight:** 1 lb [0.5 kg]

Note: Make sure to add the weight of all options to the Lifter Weight when you are selecting appropriate hoisting equipment (see ASSEMBLY in lifter's instruction manual).

## WARNINGS

---



Powr-Grip is pleased to offer the most reliable materials handling products available. Despite the high degree of security provided by the Flat Lift Adapter, certain precautions must be observed to protect the operator and others.



**Never** use a Flat Lift Adapter that is damaged, malfunctioning, or missing parts.

**Never** exceed the Maximum Load Capacity listed for the vacuum lifter (see SPECIFICATIONS in lifter's instruction manual).

**Always** install the Flat Lift Adapter as directed (see INSTALLATION).

**Always** use both cables of the Flat Lift Adapter together, since using only one adapter cable can damage the lifter and create a hazard to the operator or others.

**Always** center the long row of vacuum pads on the load's center of gravity, since positioning the load any other way could overload the Flat Lift Adapter.

**Always** remember that modifications to the Flat Lift Adapter may compromise safety. Wood's Powr-Grip cannot be responsible for the safety of a Flat Lift Adapter that has been modified by the customer. For consultation, contact Wood's Powr-Grip (see LIMITED WARRANTY).

# INSTALLATION

---

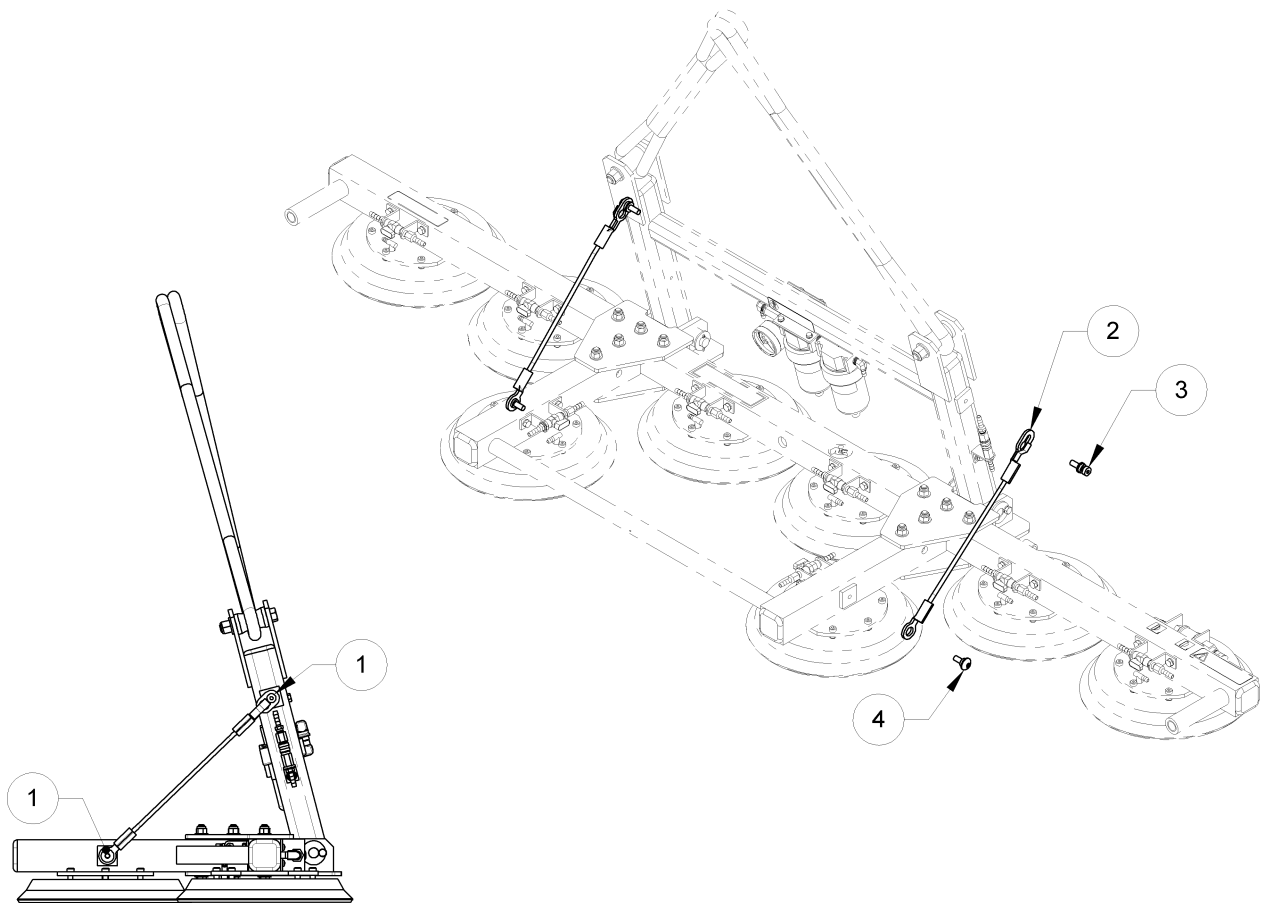

Flat Lift Adapter shown on MT8HV11F lifter.

- 1) Drill two 17/64" diameter holes for the cable bolts where indicated (1) in the illustration. All newer lifters have centering marks to indicate the exact hole locations. Repeat this step in the corresponding locations on the opposite side of the lifter.
- 2) Thread all 4 holes for the cable bolts using an M8 x 1.25-6H tap.
- 3) Connect the fixed end of one adapter cable (2) to the lifter's pad frame using a fixed-end cable bolt (4), as shown in the illustration. Tighten the cable bolt securely. Repeat this step for the other adapter cable and fixed-end cable bolt on the opposite side of the lifter.
- 4) Screw a detachable-end cable bolt (3) into position on the lifter's lift bar, as shown in the illustration. Tighten the cable bolt securely. Repeat this step for the detachable-end cable bolt on the opposite side of the lifter.

# OPERATION

---

When the Flat Lift Adapter is in use, the lifter can only be used to lift loads in the flat position. Follow the directions for applying the vacuum pads to a load in the MT Series lifter's instruction manual (see OPERATION: TO APPLY THE PADS TO A LOAD), but adjust the procedure as follows for the Flat Lift Adapter:

Before applying the lifter to the load, connect the detachable ends of both adapter cables (2) to the cable bolts (3) protruding from the lift bar, as shown in the preceding illustration. The detachable ends of the adapter cables should slide over the heads of the cable bolts and clip into position securely. Otherwise, consult the INSTALLATION section to ensure that all hardware has been installed correctly.

Note: Always use both adapter cables together. Attempting to lift a load while using only one cable can damage the lifter and create a hazard to the operator or others.

Position the pad frame on the load as necessary to keep the load balanced during the lift: The Flat Lift Adapter is designed so that the lifter hangs level when the long row of pads is centered on the load's center of gravity. ***Positioning the load any other way could overload the Flat Lift Adapter.*** Make sure that all active pads will fit entirely on the contact surface of the load and that the long row of pads will be loaded evenly while lifting.

After the lift has been completed and the load landed carefully on an appropriate support, the vacuum pads may be released as directed in the MT Series lifter's instruction manual (see OPERATION: TO RELEASE THE PADS FROM THE LOAD). When lifting requirements do not call for lifting loads in the flat position, the operator can then release the tension on the adapter cables and disconnect the detachable ends of the adapter cables from the cable bolts on the lift bar. When the cables are not in use, make sure they are positioned so they will not interfere with lifter operation.

# MAINTENANCE

---

When performing inspections and tests of the lifter as directed in the MAINTENANCE section of the lifter's instruction manual, be sure to include all components of the Flat Lift Adapter whenever applicable.

# REPLACEMENT PARTS LIST

---

Stock No.	Description	Qty.
58449	Cable Bolt - Detachable End	2
58448	Cable Bolt - Fixed End	2
58447	Adapter Cable	2

***SERVICE ONLY WITH IDENTICAL REPLACEMENT PARTS,  
AVAILABLE AT WPG.COM OR THROUGH AN AUTHORIZED WPG DEALER***

# LIMITED WARRANTY

---

Powr-Grip products are carefully constructed, thoroughly inspected at various stages of production, and individually tested. They are warranted to be free from defects in workmanship and materials for a period of one year from the date of purchase.

If a problem develops during the warranty period, follow the instructions hereafter to obtain warranty service. If inspection shows that the problem is due to defective workmanship or materials, Powr-Grip will repair the product without charge.

## ***WARRANTY DOES NOT APPLY WHEN:***

Modifications have been made to the product after leaving the factory.

Rubber portions have been cut or scratched during use.

Repairs are required due to abnormal wear and tear.

The product has been damaged, misused, or neglected.

If a problem is not covered under warranty, Powr-Grip will notify the customer of costs prior to repair. If the customer agrees to pay all repair costs and to receive the repaired product on a C.O.D. basis, Powr-Grip then will proceed with repairs.

## **TO OBTAIN REPAIRS OR WARRANTY SERVICE**

For purchases in *North America*:

Contact the Technical Service Department at Wood's Powr-Grip Co. When factory service is required, ship the complete product--prepaid--along with your name, address and phone number to the street address hereafter.

For purchases in *all other localities*:

Contact your dealer or the Technical Service Department at Wood's Powr-Grip Co. for assistance.

Wood's Powr-Grip Co., Inc.  
908 West Main St. / P.O. Box 368  
Laurel, MT USA 59044

phone 800-548-7341

phone 406-628-8231

fax 406-628-8