



## N-SERIES HYBRID VACUUM CUP

MODELS: N4300, N5300,  
N5300CS, N6300

STOCK: 91600, 91620, 91630,  
91640

Powr-Grip has taken the lightweight and rust-resistant plunger from our Industrial Plastic cup and paired it with our rugged and durable metal handle for improved tolerance to wet stone-working conditions.

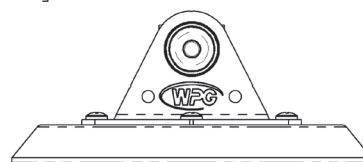
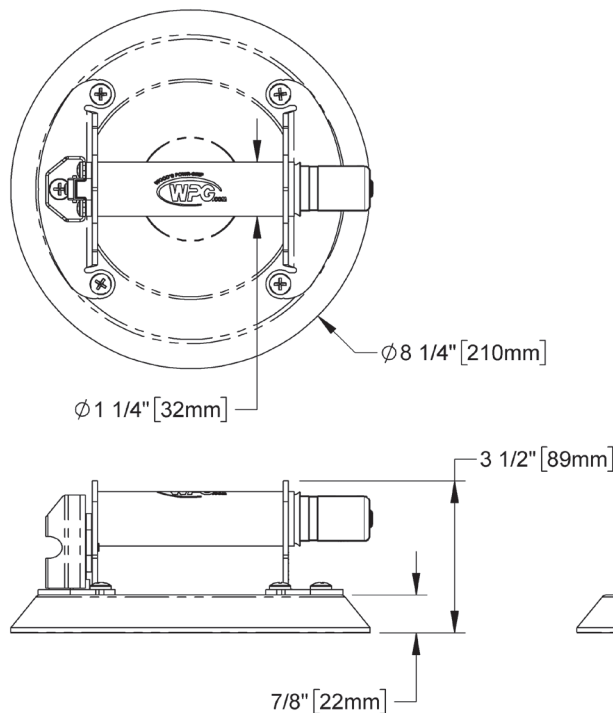

N4300 HAND CUP SHOWN

Model	N4300	N5300	N5300CS	N6300
Stock	91600	91620	91630	91640
Maximum Load Capacity	125 lbs [57 kg]	150 lbs [68 kg]	150 lbs [68 kg]	175 lbs [79 kg]
Features	Durable metal handle Red-line indicator warns user of any significant vacuum loss Eligible for WPG Hand Cup Exchange Program Supplied with protective carrying case			
Surface Texture	Smooth			
Material Porosity	Nonporous			
Allowable Surface Curvature	Flat	Flat	Flat or Curved	Curved
Minimum Radius for Curved Loads	N/A	N/A	21-1/2" [545 mm]	13" [330 mm]
Minimum Material Thickness	N/A	N/A	N/A	1/4" [6.35 mm] (for typical glass handling)
Maximum Elevation	5,000 ft [1,524 m]			
Material and Ambient Temperature Range	10° F [-12° C] – 120° F [49° C]			
Ideal Uses	Smooth, nonporous flat surfaces	Smooth, nonporous flat surfaces	Smooth or slightly textured, flat or curved surfaces	Smooth, nonporous curved surfaces
Nominal Pad Diameter	8" [20 cm]	9" [23 cm]	9" [23 cm], concave	10" [25 cm]
Pad Model	VPFS8L	G0725	VPCS9	G0750
Rubber Type	Standard			
Handle Type	Metal			
Based on product information at time of publication. Environmental conditions can affect product performance and longevity; consult the product instructions on WPG.com or contact a Technical Sales Representative for more information.				

