



POWR-FRAMES 1000 DC

MODELS: PFHL89DC & PFHS89DC

These cord-free models are a reliable lifting solution for use on loads of a specific size.

90° Tilt and 180° Rotation Capabilities

Provide operators with more load positioning versatility.

Narrow Profile

Allows lifter to be maneuvered in tight spaces.

Affordability and Safety

Come together with a fixed-sized frame that provides cost efficiency and peace-of-mind features such as a low vacuum warning light and vacuum reserve tank.

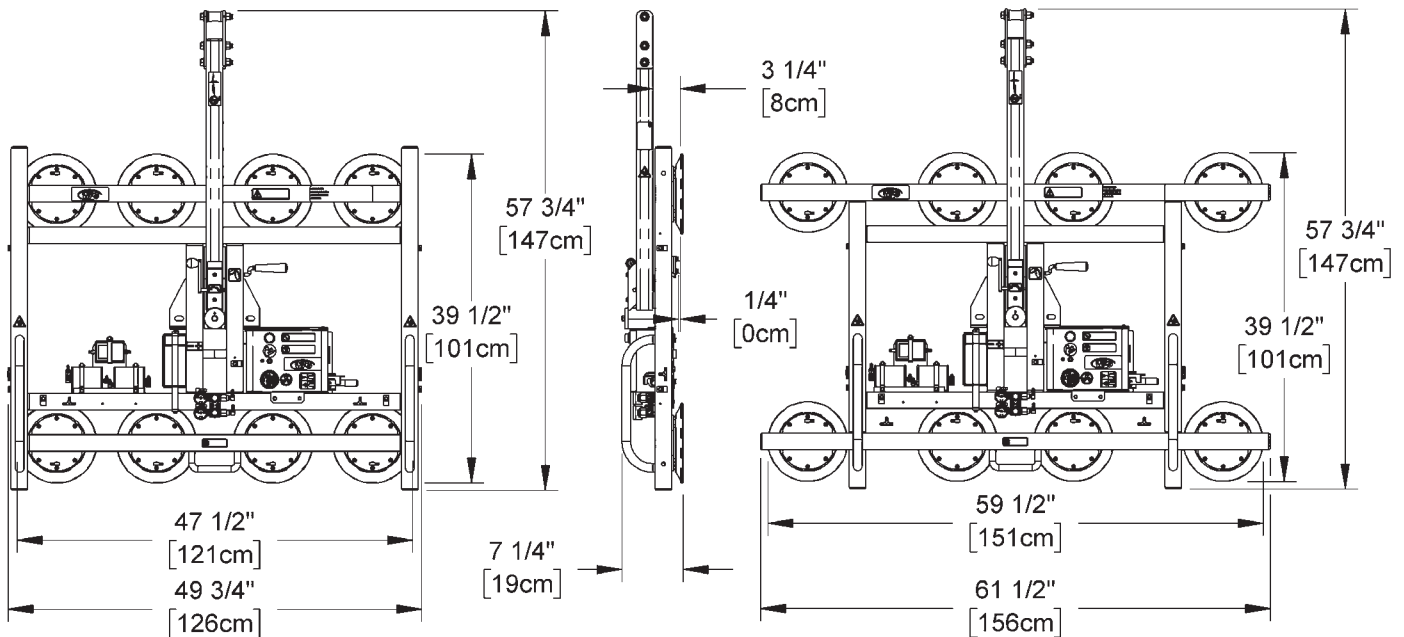
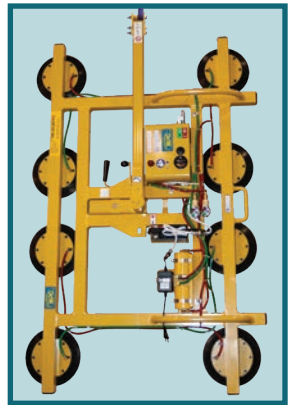
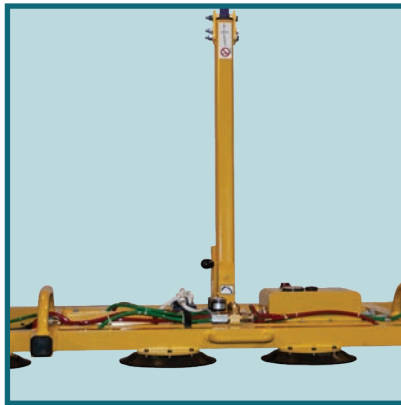

SMALL FRAME
PFHS89DC

LARGE FRAME
PFHL89DC

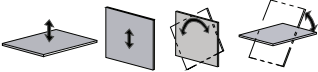
Model	PFHS89DC	PFHL89DC
Maximum Load Capacity	1,000 lbs [455 kg]	1,000 lbs [455 kg]
Standard Pad Spread	39-1/2" x 47-1/2" [101 cm x 121 mm]	39-1/2" x 59-1/2" [101 cm x 151 cm]
Number/Size of Pads	8 / 9" [23 cm] diameter	
Load Movement	Manual rotation, 180° edgewise, with locking in three positions. Manual tilt, 90° between upright and flat, with automatic latching in upright position (in center rotation position, as shown on drawings). 	
Standard Operating Power	12 volts DC, 3.5 amps	
Lifter Weight	130 lbs [59 kg]	

STANDARD FEATURES

Battery and Charger

Provide independent, rechargeable power source for cord-free lifter operation in any location; on-board charger features automatic shut-off

Battery Gauge

Shows energy level in real time, to help determine when charging is needed

Low Vacuum Warning Light

Uses red light to warn operator when vacuum is not sufficient for lifting

Vacuum Gauge

Features green and red zones, to clearly indicate whether vacuum level is sufficient for lifting

Vacuum Line Filter

Protects the vacuum generating system from contaminants

Vacuum Reserve Tank

Increases battery run-time by reducing pump cycles needed to maintain vacuum

Spring-Mounted Vacuum Pads

Automatically adjust to match the angle of load surfaces, easing attachment

AVAILABLE OPTIONS

Air (Venturi) Power System (PFHL89AIRS, PFHS89AIRS)

Enables lifter to operate using compressed air supply already available in many production facilities (Specifications may not be as listed. Please contact us for more information.)

Vacuum Loss Warning Buzzer (93780AM)

Uses advanced logic circuitry to monitor vacuum level and sound an alarm only when insufficient vacuum could be hazardous

Individual Pad Shutoffs (93011)

Enable lifter to handle various load sizes and shapes by shutting off airflow from specific vacuum pads

Pad Shutoffs Kit with Individual Gauges

Provides the same advantages as 93011, while adding vacuum gauges to monitor the vacuum level at each vacuum pad

Alternative Vacuum Pads

Adapt lifter to specialized uses, including: 10" [25 cm] diameter, lipped vacuum pads (HV11) for handling rough or semiporous loads (Specifications not as listed above. Please contact us for more information.)

Alternative Pad Compounds

Specially designed for heat resistance, marking resistance, coated surfaces and other purposes

Custom Pad Frame Sizes and Capacities

Accommodate customers' specific load weight and dimension requirements

DESIGN STANDARDS

ASME B30.20 (BTH-1 Design Category "B", Service Class "0"): Industry standards established by the American Society of Mechanical Engineers (ASME) and published by the American National Standards Institute (ANSI)

Based on product information at time of publication. Environmental conditions can affect product performance and longevity; consult the product instructions on WPG.com or contact a Technical Sales Representative for more information.