



P1 COMPACT SERIES CHANNEL LIFTER WITH DC3 DUAL VACUUM SYSTEM MODEL: P1HV1102DC3

All the versatility of Powr-Grip's 4-pad channel lifter now comes in a more compact design!

Compact Channel Design

Gives operators the combination of tilt/rotation capabilities and an agile frame for installation in tight spaces.

Light Weight

Makes it an economical choice for smaller loads (up to 350 lbs., when using model P11102DC3)

Intelli-Grip[®] Technology

This WPG-exclusive technology oversees power and vacuum systems, increasing productivity and improving safety. Download the Intelli-Grip App to monitor the lifter from a distance!

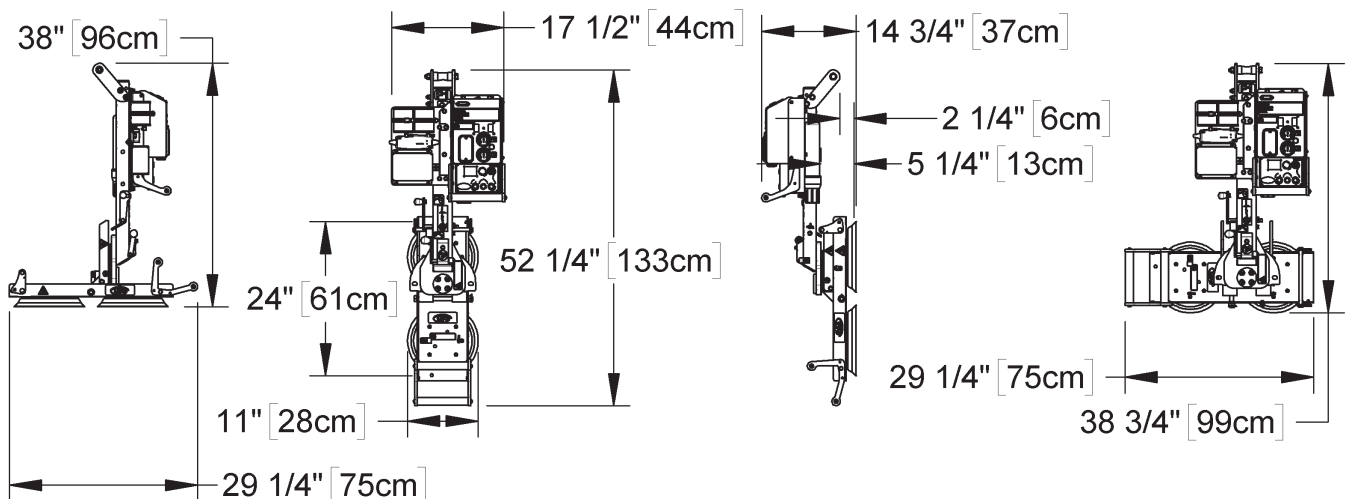

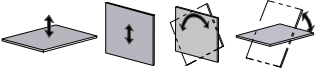
Model	P1HV1102DC3
Maximum Load Capacity	300 lbs [135 kg]*
Standard Pad Spread	24" x 11" [61 cm x 28 cm]
Number/Size of Pads	2 / 10" [25 cm] dia. lipped vacuum pads
Load Movement	Manual rotation, 180° edgewise, with locking at each 1/4 turn. Manual tilt, 90° between upright and flat, with automatic latching in upright position (in center rotation position, as shown on drawings).
	
Standard Operating Power	12 volts DC, 5.5 amps
Lifter Weight	85 lbs [39 kg]



*EU REQUIRES A SECONDARY SAFETY DEVICE WHEN USED ON CONSTRUCTION SITES.

STANDARD FEATURES

Intelli-Grip® Technology

Available exclusively from Powr-Grip®! Actively monitors power and vacuum systems to increase safety and productivity, using LCD-screen messages, diagnostic codes and other features

Dual Vacuum System

Features two independent air-line circuits to reduce risk of workplace accidents

High-Flow Vacuum Pump

Enables a vacuum lifter to attach and release more rapidly, increasing productivity on the job

Adjustable-Position Lift Spool

Provides different lift points to optimize the lifter's hang angle, making repetitive material placement quicker and easier

Battery and Charger

Provide independent, rechargeable power source for cord-free lifter operation in any location; on-board charger features status indicator and automatic shut-off

Battery Gauge

Shows energy level in real time, to help determine when charging is needed

Notification Buzzer and Strobe Light

Alert operator of problems with power or vacuum system, with various patterns of sound and light to indicate severity; back-up battery provides independent power for buzzer

Green Lift Light

Provides visual assurance to know when vacuum is sufficient for lifting

Vacuum Gauges

Feature green and red zones to clearly indicate whether vacuum levels are sufficient for lifting

Vacuum Line Filters

Prevent contaminants from damaging the vacuum generating system

Vacuum Reserve Tanks

Increase battery run-time by reducing pump cycles needed to maintain vacuum

Two-Action, Blow-Off Release

Uses two separate buttons to avoid accidental release, and reverses airflow to quickly release loads without after-stick

AVAILABLE OPTIONS

Remote Control System (59906)

Controls attach, release and other powered functions up to 250' [76 m] away for installing windows and more in multi-story buildings

Alternative Vacuum Pads

Adapt lifter to specialized uses, including:

10" [25 cm] diameter concave pad (G0750) for handling curved loads

10" [25 cm] diameter pad with replaceable sealing ring (VPFS10T) for handling Insulated Metal Panels or other textured loads

11" [28 cm] diameter, lipped pad (G3370) for handling rigid, flat loads

(Specifications not as previously listed. Please contact us for more information)

Alternative Pad Compounds

Specially designed for heat resistance, marking resistance, coated surfaces and other purposes

DESIGN STANDARDS

ASME B30.20 (BTH-1 Design Category "B", Service Class "0"): Industry standards established by the American Society of Mechanical Engineers (ASME) and published by the American National Standards Institute (ANSI)

CE: Regulatory standards for health and safety required in the European Union

AS 4991: Regulatory standard required in Australia

