

KEEP FOR FUTURE REFERENCE

# INSTRUCTIONS

# MANUAL



908 W. Main • P.O. Box 368

Laurel, MT USA 59044

800-548-7341 (phone)

406-628-8231 (phone)

406-628-8354 (fax)

[www.WPG.com](http://www.WPG.com)

 **INTENDED FOR USE BY SKILLED PROFESSIONALS • READ AND UNDERSTAND BEFORE INSTALLING AND OPERATING**

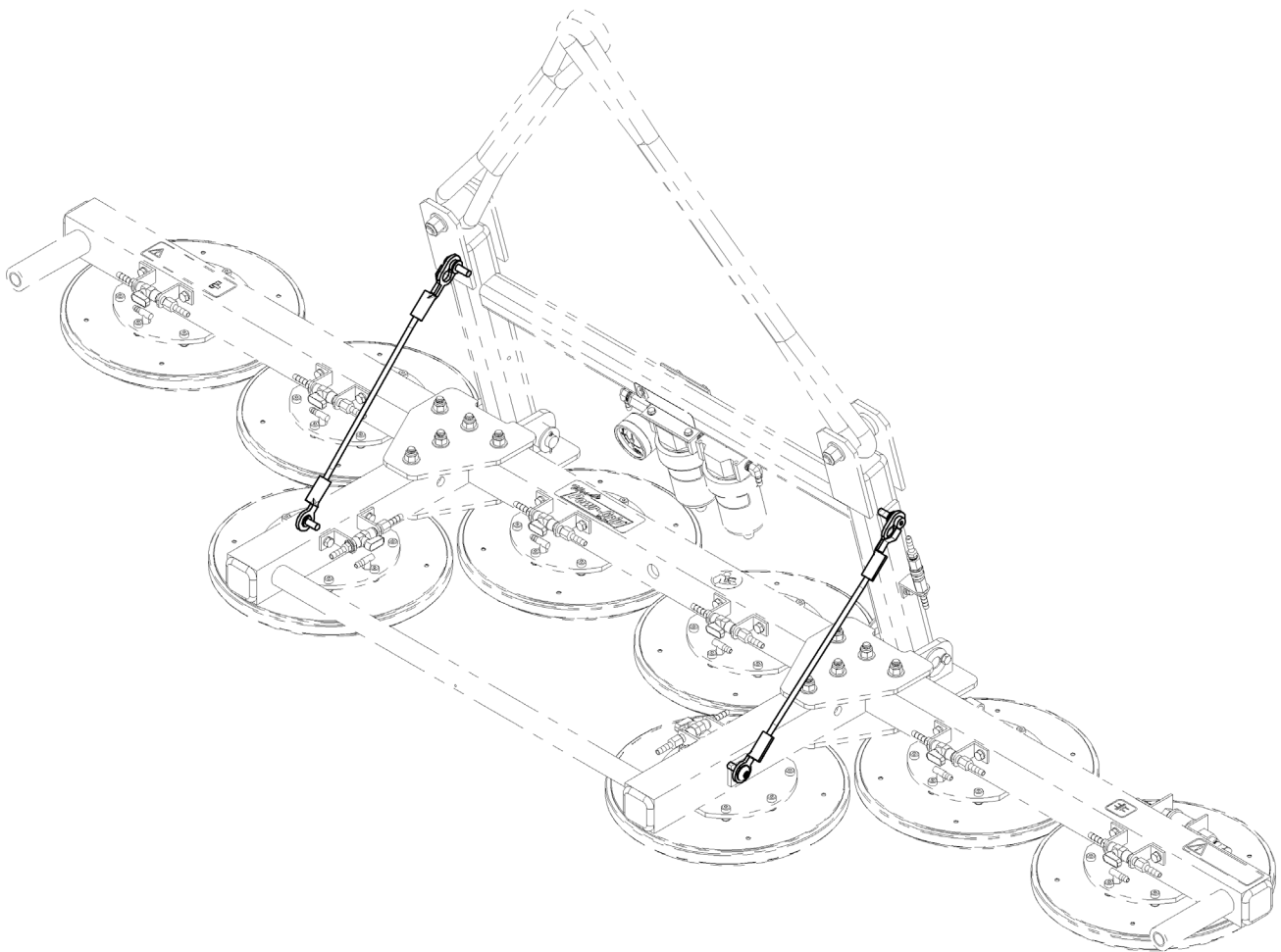

**MT SERIES**  
**FLAT LIFT ADAPTER**

Stock number: 95902



# TABLE OF CONTENTS

<b>SPECIFICATIONS .....</b>	<b>2</b>
<b>INSTALLATION .....</b>	<b>2</b>
<b>OPERATION.....</b>	<b>3</b>
<b>REPLACEMENT PARTS.....</b>	<b>3</b>
<b>LIMITED WARRANTY .....</b>	<b>4</b>
<b>ABOUT THE LIMITED WARRANTY .....</b>	<b>4</b>
Obtaining Warranty Service or Repair Service.....	4

# SPECIFICATIONS

<b>Product Description</b>	This option allows a MT Series vacuum lifter to lift loads encountered in the flat position, by securing the pad frame in the horizontal orientation.
<b>Stock Number</b>	95902
 <b>Product Weight</b>	1 lb [0.5 kg] <i>Note: This weight should be added to the Lifter Weight when determining hoisting equipment capacity.</i>

*Note: Before installing and using the MT Series Flat Lift Adapter, read and understand the lifter's OPERATING INSTRUCTIONS. Intended use, storage, inspections, tests and maintenance in the lifter's instructions should be understood to include options, when relevant. All warnings in the "SAFETY" section, as well as alerts in other sections, are applicable when using the Flat Lift Adapter.*

# INSTALLATION

- 1) Drill two 17/64" diameter holes for the cable bolts where indicated in the illustration (item 1); the lifter has centering marks that indicate the exact hole locations.<sup>1</sup> Repeat this step in the corresponding locations on the opposite side of the lifter.
- 2) Thread all 4 holes using an M8 x 1.25-6H tap.
- 3) Connect the fixed end of one adapter cable (item 2) to the lifter's pad frame using a fixed-end cable bolt (item 4), as shown. Tighten the cable bolt securely. Repeat this step for the corresponding cable and bolt on the opposite side of the lifter.
- 4) Screw a detachable-end cable bolt (item 3) into position on the lifter's lift bar, as shown. Tighten the cable bolt securely. Repeat this step for the corresponding bolt on the opposite side of the lifter.

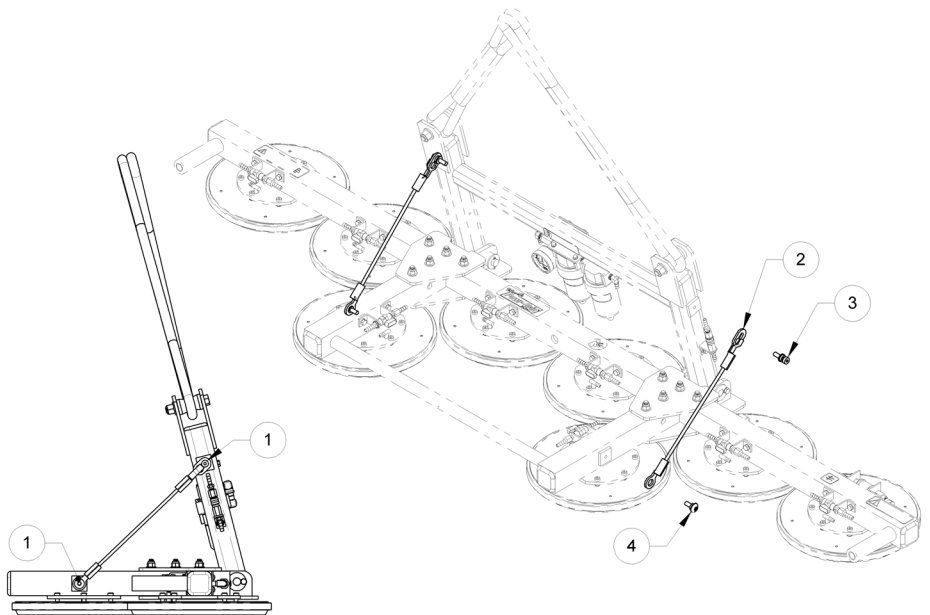

1..... Some older MT Series lifters may not have these centering marks.

# OPERATION

When the Flat Lift Adapter is in use, the MT Series lifter can only be used to lift loads in the flat position.

Always use both adapter cables together.



**Do not attempt to lift load while using only one adapter cable, which could result in personal injury or damage to lifter and load.**

Before attaching the lifter to the load, connect the detachable ends of both adapter cables (2) to the cable bolts (3) protruding from the lift bar, as shown on the previous page. The detachable ends of the adapter cables should slide over the heads of the cable bolts and clip into position securely. If they do not, make sure the hardware has been installed correctly (see “INSTALLATION”) and try again.

*Note: The Flat Lift Adapter is designed so that the lifter hangs level when the long row of pads is centered on the load’s center of gravity. **Positioning the load any other way could overload the Flat Lift Adapter.** Make sure all activated pads will fit on the load and will be loaded evenly.*

After the load has been landed and the lifter’s vacuum pads have been released, you can release the tension on the adapter cables and disconnect the detachable ends of the adapter cables from the cable bolts on the lift bar.

When the cables are not in use, make sure they are positioned so they will not interfere with lifter operation.

# REPLACEMENT PARTS

Stock No.	Description	Qty.
58449	Cable Bolt — Detachable End	2
58448	Cable Bolt — Fixed End	2
58447	Adapter Cable	2

**SERVICE ONLY WITH IDENTICAL REPLACEMENT PARTS,  
AVAILABLE AT [WPG.COM](http://WPG.COM) OR THROUGH AN AUTHORIZED WPG DEALER**

# LIMITED WARRANTY

## ABOUT THE LIMITED WARRANTY



Note: Read the [WARRANTY RETURN FORM](#) at [wpg.com](#) for important details about the Limited Warranty.

Wood's Powr-Grip® (WPG) products are warranted to be free from defects in manufacturing and materials for 1 year from the date of purchase.

If a problem develops during the warranty period, follow the instructions below to obtain warranty service. If inspection shows that the product has a defect, WPG will repair or replace the product without charge.



## Obtaining Warranty Service or Repair Service

**For customers in the U.S. and Canada:** Go to the [EXCHANGES, REPAIRS, & WARRANTIES](#) page at [wpg.com](#) and click the applicable link. Alternatively, you may contact the WPG Technical Service Department (see contact information at right).

**For customers in all other localities:** Contact the WPG Technical Service Department (see contact information at right) or your dealer for assistance.

**Address:**

Wood's Powr-Grip Co., Inc.  
908 West Main St.  
Laurel, MT 59044 USA

**Email:**

[contactus@wpg.com](mailto:contactus@wpg.com)

**Phone:**

800-548-7341 or 406-628-8231

**Fax:**

406-628-8354