

KEEP FOR FUTURE REFERENCE



*P.O. Box 368 – 908 West Main
Laurel, MT USA 59044
phone 800-548-7341
phone 406-628-8231
fax 406-628-8354*

INSTRUCTIONS

International Version



SPRING-SHAFT PAD MOUNTS



***READ ALL INSTRUCTIONS AND WARNINGS
BEFORE OPERATING THIS PRODUCT***



DESIGNED FOR THE MATERIALS HANDLING PROFESSIONAL

WARNINGS



Powr-Grip is pleased to offer the most reliable vacuum products available. Despite the high degree of security provided by the Sliding Pad Mount, certain precautions must be observed to protect the operator and others.



Never use pad mounts that are damaged, malfunctioning, or missing parts.

Never exceed the lifter's Load Capacity (see SPECIFICATIONS in lifter's instruction manual) or attempt to lift loads the lifter is not designed for (see INTENDED USE in lifter's instruction manual).

Always position the vacuum pads correctly on the load prior to lifting (see OPERATION).

Never lift a load when any vacuum indicator shows inadequate vacuum.

Always keep other personnel far enough away from the lifter to avoid injury in the event of an unexpected load release.

Always remember that modifications to pad mounts may compromise its safety. Wood's Powr-Grip cannot be responsible for the safety of pad mounts that have been modified by the customer. For consultation, contact Wood's Powr-Grip (see LIMITED WARRANTY).

SPECIFICATIONS

Description: Spring-Shaft Pad Mounts offer many advantages over standard pad mounts: When a WPG Flat Lifter is applied to loads, the mounts' spring suspension reduces shocks and compensates for some variations in the height of load surfaces. It also evens out the amount of load weight supported by each of the pads and to reduce stress on loads, should they tend to flex during a lift. Spring-Shaft Pad Mounts provide extra clearance between the pad frame and the load, in order to bridge across a framework or similar obstructions on a load surface.

Weight Increase: 6 lbs [2.75 kg] per pad mount

Note: Add the weight of all options to the lifter weight when selecting appropriate hoisting equipment (see assembly in lifter's main instructions).

OPERATING FEATURES

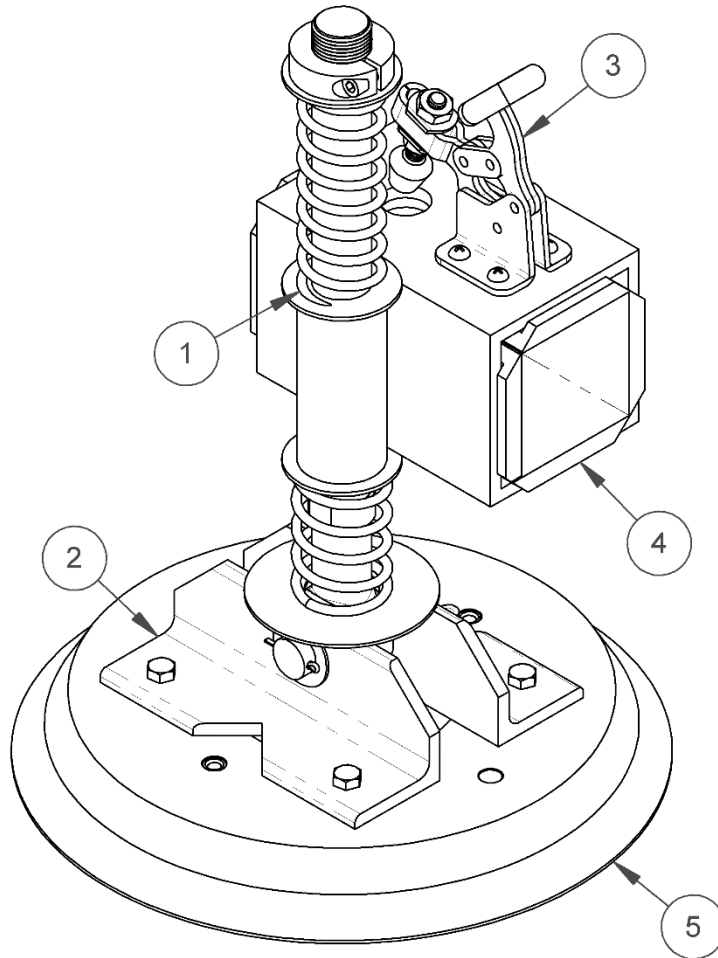

Sliding Spring-Shaft Pad Mount Shown

- 1) SHAFT WITH CUSHION SPRINGS
- 2) PAD MOUNTING BRACKET
- 3) TOGGLE CLAMP*
- 4) SLIDING BEARING*
- 5) VACUUM PAD

*NOTE: Only applicable to sliding spring-shaft pad mounts.

FUNCTION

 **WARNING:** *Spring-shaft pad mounts are designed for use on flat lifters. Using spring-shaft pad mounts on other lifters may affect capacity. Contact WPG for help in determining reduced capacities.*

INSTALLATION

Position all pad mounts at an equal distance from the center of the lifter.

Fixed: All fixed spring-shaft pad mounts must be ordered with the lifter. Pad mounts will be installed by the manufacturer.

Pin: Pin spring-shaft pad mounts are adjustable by sliding the pad mount to various, set locations and securing the pad via a cotterless hitch pin. Remove the cotterless hitch pin from the sliding weldment on the pad mount assembly. Slide the pad mount assembly onto the pad frame. Align the hole in the sliding weldment with the desired hole on the pad frame. Reinsert the cotterless hitch pin to secure the pad mount assembly. Make sure the vacuum hose does not get pinched during and after installation.

Sliding: Sliding spring-shaft pad mounts have infinitely adjustable positioning due to the toggle clamp. Remove the stop pin on the pad frame. Pull up on the sliding pad mount assembly's toggle clamp to release. Slide the pad mount onto the pad frame and move to the desired position, making sure the vacuum hose does not get pinched. Push down on the toggle clamp to secure the pad mount assembly. Reinstall the stop pin on the pad frame.

OPERATION

Fixed: Fixed spring-shaft pad mounts do not dramatically change the functions of lifters typically equipped with standard pad mounts. Operate the lifter as directed in the OPERATION section of the main instructions.

Pin: Before operating, inspect each pad mount for damage and worn parts. Replace as needed.

Sliding: Before operating, inspect each pad mount for damage and worn parts. Make sure that the brake pad is not worn so metal is exposed. Press down on each clamp to see if the pad mount holds securely in place. Adjust if necessary:

If too loose: Release the clamp, loosen the upper adjustment nut and tighten the lower adjustment nut. Adjust by one complete turn at a time.

If too tight: Release the clamp, loosen the lower adjustment nut and tighten the upper adjustment nut. Adjust by one complete turn at a time.

INSPECTIONS & TESTING

When performing inspections and tests of the lifter as directed in the MAINTENANCE section of the main instructions, be sure to include all components of the spring-shaft pad mounts whenever applicable.

REPLACEMENT PARTS LIST

Stock No.	Description	Qty.
	Fixed Spring-Shaft Large Pad Mount Assembly	A/R
	Pinned Spring-Shaft Large Pad Mount Assembly	A/R
	Sliding Spring-Shaft Large Pad Mount Assembly	A/R

***SERVICE ONLY WITH IDENTICAL REPLACEMENT PARTS,
AVAILABLE AT WPG.COM OR THROUGH AN AUTHORIZED WPG DEALER***