

KEEP FOR FUTURE REFERENCE



*P.O. Box 368 – 908 West Main
Laurel, MT USA 59044
phone 800-548-7341
phone 406-628-8231
fax 406-628-8354*

INSTRUCTIONS

International Version

STOCK NUMBERS: 93100(AM) & 93101(AM)

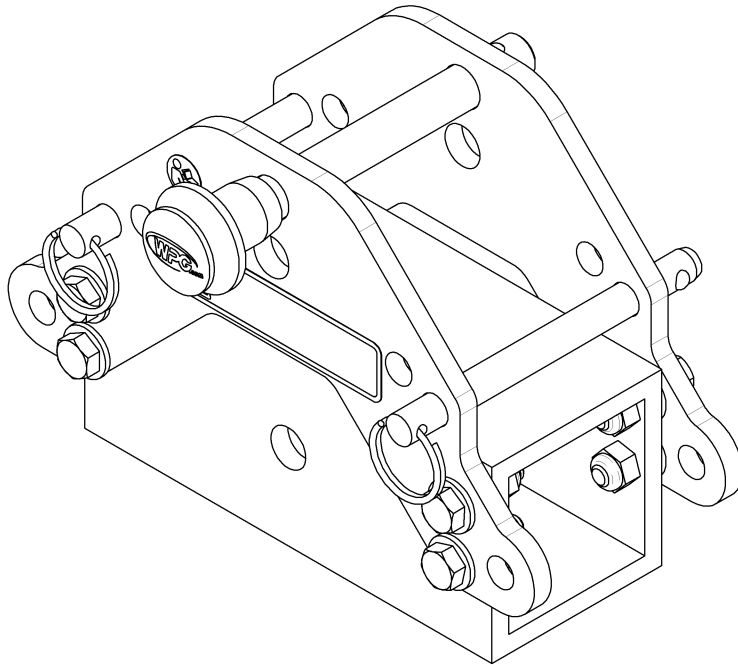

**ADJUSTABLE SPACERS FOR
MOVABLE PAD MOUNTS**



***READ ALL INSTRUCTIONS AND WARNINGS
BEFORE USING THIS PRODUCT***



DESIGNED FOR THE MATERIALS HANDLING PROFESSIONAL

SPECIFICATIONS

Stock Numbers: 93100, 93100AM, 93101, 93101AM

Description: By increasing the distance between the vacuum lifter's pad frame and the contact surface of the load, this option enables the lifter to handle windows with mullions or similar loads with surface obstructions.

Spacer Dimensions:

Pad Frame Tube Width:	2" [51 mm]		2-1/2" [63 mm]	
Stock Number:	93100	93100AM	93101	93101AM
Spacer Tube Dimensions:	2" x 2" [51 x 51 mm]	2" x 3" [51 x 76 mm]	2-1/2" x 2-1/2" [63 x 63 mm]	2-1/2" x 3-1/2" [63 x 89 mm]
Minimum – Maximum Spacing Distance:	2-1/16" – 2-13/16" [52 – 71 mm]	3-1/16" – 3-13/16" [78 – 97 mm]	2-9/16" – 3-5/16" [65 – 84 mm]	3-9/16" – 4-5/16" [90 – 109 mm]

Maximum Structural Capacity per Adjustable Spacer: 184 lbs [83 kg]

Reduced Load Capacity of Vacuum Lifter:

Lifter Model	2-1/2" x 2-1/2" [63 x 63 mm] Spacer Tube		2-1/2" x 3-1/2" [63 x 89 mm] Spacer Tube	
	Minimum Spacing 2-9/16" [65 mm]	Maximum Spacing 3-5/16" [84 mm]	Minimum Spacing 3-9/16" [90 mm]	Maximum Spacing 4-5/16" [109 mm]
MRT4-DC	370 lbs [167 kg]	325 lbs [147 kg]	310 lbs [140 kg]	265 lbs [120 kg]
MRTALP6/811LDC(3)	970 lbs [440 kg]	930 lbs [421 kg]	920 lbs [417 kg]	880 lbs [399 kg]
MRTA611LDC	1025 lbs [465 kg]	990 lbs [450 kg]	975 lbs [442 kg]	940 lbs [426 kg]
MRTA811LDC3	1320 lbs [598 kg]	1280 lbs [580 kg]	1270 lbs [576 kg]	1240 lbs [562 lbs]

Note: Load capacities of Flat Lifters are not affected by the use of Adjustable Spacers. For other lifters that are not listed above, contact Wood's Powr-Grip to determine reduced load capacities.

Weight Increase: 5 lbs [2.3 kg] per Adjustable Spacer installed.¹

WARNINGS



Powr-Grip is pleased to offer the most reliable materials handling products available. Despite the high degree of security provided by Adjustable Spacers, certain precautions must be observed to protect the lifter operator and others.



Never use an Adjustable Spacer that is damaged, malfunctioning, or missing parts.

Never exceed the Load Capacity listed for the Adjustable Spacers (see SPECIFICATIONS).

Never remove or obscure any warning labels.

Always remember that modifications to an Adjustable Spacer may compromise its safety.

Wood's Powr-Grip cannot be responsible for the safety of an Adjustable Spacer that has been modified by the customer. For consultation, contact Wood's Powr-Grip (see LIMITED WARRANTY).

¹ This weight should be added to the lifter weight when determining hoisting equipment capacity.

ASSEMBLY

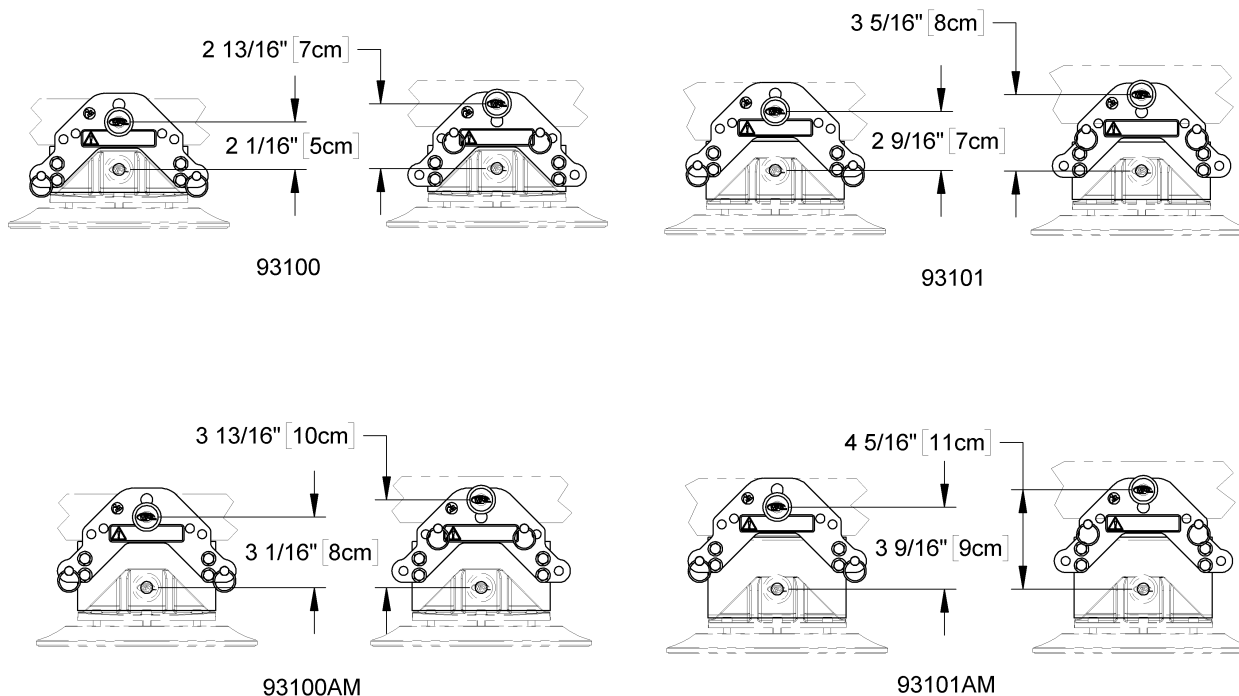

Adjustable Spacers shown mounted on pad frame tubes

Arrange the movable pad mounts on the vacuum lifter as necessary to provide optimal support of the load while lifting, as directed in the ASSEMBLY or OPERATION section of the lifter's instruction manual. At the same time, install an Adjustable Spacer between the pad frame and each movable pad mount on the lifter, as follows:

1. Select the desired Spacing Distance for your application (see SPECIFICATIONS preceding), based on the width of your lifter's pad frame tube and the dimensions of the spacer tube supplied with your Adjustable Spacer.
2. Insert the cotterless hitch pins securely according to the pattern shown in the corresponding illustration above. Each spacer is adjustable, to produce the minimum or maximum spacing distance. Use the smallest spacing distance that will allow the lifter to clear any obstructions on the load surface when the vacuum pads are fully applied to the load.
3. Make sure all Adjustable Spacers employed on the lifter are adjusted to produce the same spacing distance.

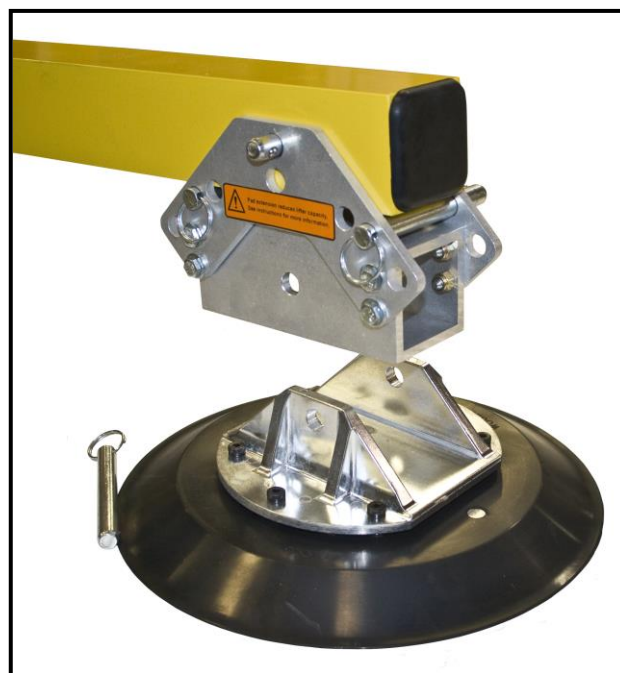

OPERATION

 **WARNING: Using Adjustable Spacers can reduce load capacity of lifter.**

When evaluating the intended use of the vacuum lifter as directed in the OPERATION section of the lifter's instruction manual, be sure to consider the Reduced Load Capacity indicated in the SPECIFICATIONS above (**not** the capacity listed in the lifter's instructions). Find the appropriate load capacity for a lifter with Adjustable Spacers, based on your lifter model, spacer tube size and spacing distance (minimum or maximum). Otherwise, operate the lifter as directed in the OPERATION section of the lifter's instruction manual.

MAINTENANCE

When performing inspections and tests as directed in the MAINTENANCE section of the lifter's instruction manual, be sure to include all parts of the Adjustable Spacers whenever applicable.

REPLACEMENT PARTS LIST

Stock No.	Description	Quantity
13532	Cotterless Hitch Pin – 1/2" x 4"	1 per Spacer
13530	Cotterless Hitch Pin – 1/2" x 3-1/2"	1 per Spacer
13524	Cotterless Hitch Pin – 3/8" x 4"	2 per Spacer
13520	Cotterless Hitch Pine – 3/8" x 3"	2 per Spacer

***SERVICE ONLY WITH IDENTICAL REPLACEMENT PARTS,
AVAILABLE AT WPG.COM OR THROUGH AN AUTHORIZED WPG DEALER***

LIMITED WARRANTY

Powr-Grip products are carefully constructed, thoroughly inspected at various stages of production, and individually tested. They are warranted to be free from defects in workmanship and materials for a period of one year from the date of purchase.

If a problem develops during the warranty period, follow the instructions hereafter to obtain warranty service. If inspection shows that the problem is due to defective workmanship or materials, Powr-Grip will repair the product without charge.

WARRANTY DOES NOT APPLY WHEN:

Modifications have been made to the product after leaving the factory.

Rubber portions have been cut or scratched during use.

Repairs are required due to abnormal wear and tear.

The product has been damaged, misused, or neglected.

If a problem is not covered under warranty, Powr-Grip will notify the customer of costs prior to repair. If the customer agrees to pay all repair costs and to receive the repaired product on a C.O.D. basis, Powr-Grip then will proceed with repairs.

TO OBTAIN REPAIRS OR WARRANTY SERVICE

For purchases in *North America*:

Contact the Technical Service Department at Wood's Powr-Grip Co. When factory service is required, ship the complete product—prepaid—along with your name, address and phone number to the street address hereafter.

For purchases in *all other localities*:

Contact your dealer or the Technical Service Department at Wood's Powr-Grip Co. for assistance.

Wood's Powr-Grip Co., Inc.
908 West Main St. / P.O. Box 368
Laurel, MT USA 59044

phone 800-548-7341

phone 406-628-8231

fax 406-628-8354