

KEEP FOR FUTURE REFERENCE

INSTALLATION INSTRUCTIONS



908 W. Main • P.O. Box 368
Laurel, MT USA 59044
800-548-7341 (phone)
406-628-8231 (phone)
406-628-8354 (fax)
www.WPG.com

 **INTENDED FOR USE BY SKILLED
PROFESSIONALS • READ AND
UNDERSTAND BEFORE INSTALLING**

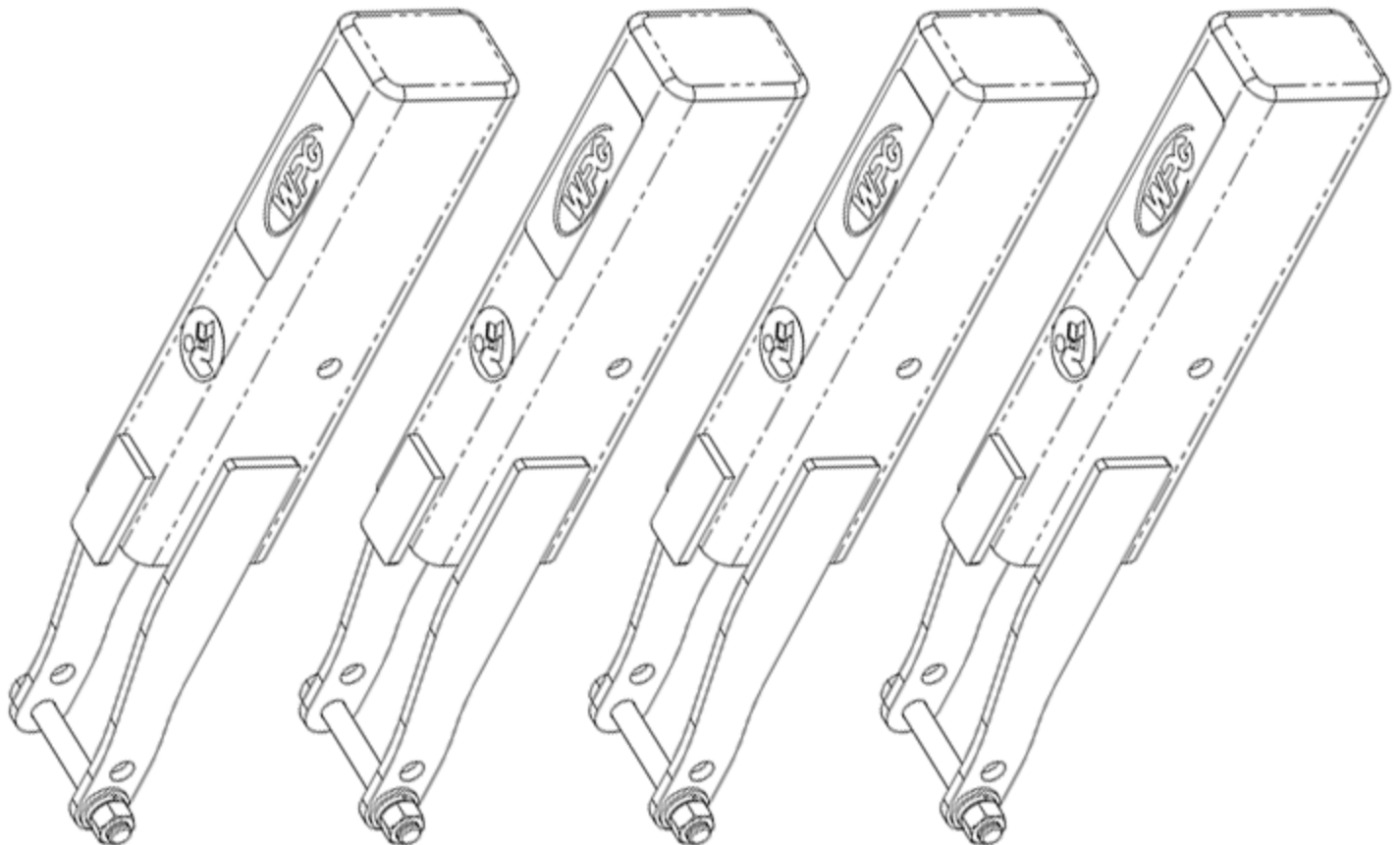

**PT10 PAD FRAME
EXTENSION ARMS**

Stock number: 95859

SPECIFICATIONS

Product Description	Designed for use with model PT10 vacuum lifters, Pad Frame Extension Arms reduce overhang on loads, enabling the lifter to handle loads with larger dimensions.
Stock Number	95859
Adjusted Pad Spread	Each extension arm extends the vacuum pad location outward from its standard location, when the extension arm is installed (see "SPECIFICATIONS" in the lifter's <i>OPERATING INSTRUCTIONS</i>). The exact extension distance depends on the manufacturing date of the lifter, as follows:
After 4/1/14	12" [30.5 cm]
Before 4/1/14	11" [28 cm]
Weight Increase	56 lbs [26 kg] with 4 Extension Arms installed (14 lbs [6.5 kg] per arm) <i>Note: This weight should be added to the Lifter Weight when determining hoisting equipment capacity.</i>

Note: Before installing the PT10 Pad Frame Extension Arms read, understand and follow the lifter's OPERATING INSTRUCTIONS except when directed differently in these option instructions. Intended use, operation, storage, inspections, tests and maintenance in the lifter's instructions should be understood to include options, when relevant. All warnings in the "SAFETY" section, as well as alerts in other sections, are applicable when using the Extension Arms.

FEATURES

Features shown here are underlined on their first appearance in each section following.

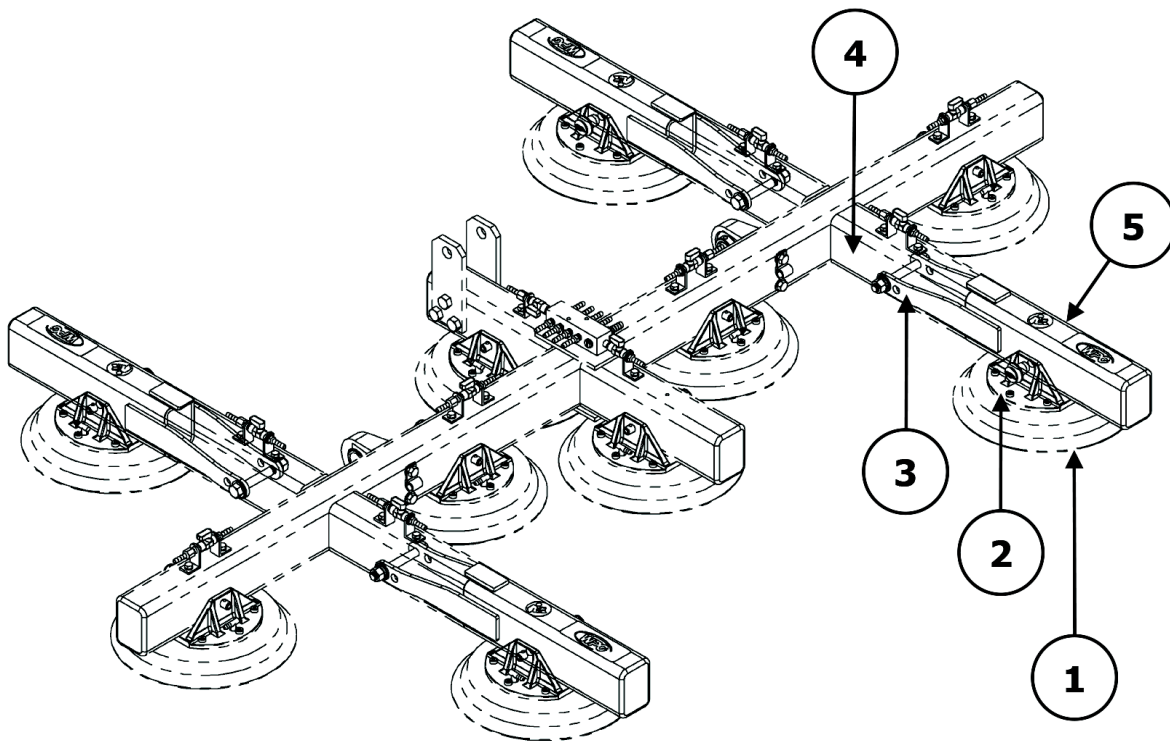

- 1 VACUUM PAD
- 4 PAD FRAME TUBE

- 2 PAD MOUNT
- 5 EXTENSION ARM

- 3 EXTENSION ARM STRAP

INSTALLATION

Assemble the vacuum lifter as directed in the "ASSEMBLY" section of the lifter's *OPERATING INSTRUCTIONS*. Then install Pad Frame Extension Arms where required to provide optimal load support:

 **Do not use Extension Arms to increase long dimension of pad frame (see drawing on page 3).**

- 1) Remove the hardware that secures a pad mount to a pad frame tube.¹
- 2) Remove the pad mount and the end plug from the pad frame tube.
- 3) Slide the end of an extension arm over the pad frame tube:

- For lifters manufactured *after* April 1, 2014, the holes *nearest* to the end of the extension arm straps should align with holes in the tube; fig. 3A shows the provided hardware installed in these holes.
- For lifters manufactured *before* April 1, 2014, the holes *farthest* from the end of the straps should align with holes in the tube.

3A

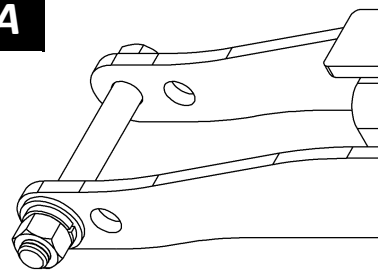

- 4) Install the provided hardware in the aligned holes, to secure the extension arm to the pad frame tube. Make sure to tighten the hardware securely.
- 5) Position the pad mount on the extension arm, aligning the holes in the pad mount with the corresponding holes in the extension arm. Then reinstall the removed hardware.²
- 6) Repeat steps 1-5 to install other extension arms as needed to provide optimal support across the load surface and to minimize load overhang.

 **Make sure all vacuum hoses function correctly.**

REPLACEMENT PARTS

Stock No.	Description	Qty.
49190	End Plug - 2 1/2" x 3 1/2" x 1/4" Tubing Size	4
12826	1/2" Flat Washer	8
12760	1/2" Split Lock Washer	4
11124	1/2-13 Hex Nut	4
10854	1/2-13 x 4" Hex Head Bolt	4

1..... If the hardware is composed of a bolt, washers and a nut, note the order of these components for reinstallation. If the pad mount is secured by a cotterless hitch pin, simply remove the pin.

2..... If the hardware is composed of a bolt, washers and a nut, make sure to tighten the hardware securely. Otherwise, simply reinstall the cotterless hitch pin to secure the pad mount.

LIMITED WARRANTY

Wood's Powr-Grip® (WPG) products are carefully constructed, thoroughly inspected at various stages of production, and individually tested. They are warranted to be free from defects in workmanship and materials for a period of one year from the date of purchase.

If a problem develops during the warranty period, follow the instructions below to obtain warranty service. If inspection shows that the problem is due to defective workmanship or materials, WPG will repair the product without charge.

Warranty does not apply when ...

- modifications have been made to the product after leaving the factory
- rubber portions have been cut or scratched during use;
- repairs are required due to abnormal wear and tear, and/or;
- the product has been damaged, misused or neglected.

If a problem is not covered under warranty, WPG will notify the customer of costs prior to repair. If the customer agrees to pay all repair costs and to receive the repaired product on a C.O.D. basis, then WPG will proceed with repairs.

TO OBTAIN REPAIRS OR WARRANTY SERVICE

For purchases in *North America*:

Contact the WPG Technical Service Department. When factory service is required, ship the complete product – prepaid – along with your name, address and phone number to the street address listed at the bottom of this page. WPG may be reached by phone or fax numbers listed below.

For purchases in all *other localities*:

Contact your dealer or the WPG Technical Service Department for assistance. WPG may be reached by phone or fax numbers listed below.

Wood's Powr-Grip Co., Inc.

908 West Main St.

Laurel, MT 59044 USA

406-628-8231 (phone)

800-548-7341 (phone)

406-628-8354 (fax)