

KEEP FOR FUTURE REFERENCE

INSTALLATION INSTRUCTIONS



908 W. Main • P.O. Box 368
Laurel, MT USA 59044
800-548-7341 (phone)
406-628-8231 (phone)
406-628-8354 (fax)
www.WPG.com

 **INTENDED FOR USE BY SKILLED
TECHNICAL PROFESSIONALS • READ
AND UNDERSTAND BEFORE INSTALLING**

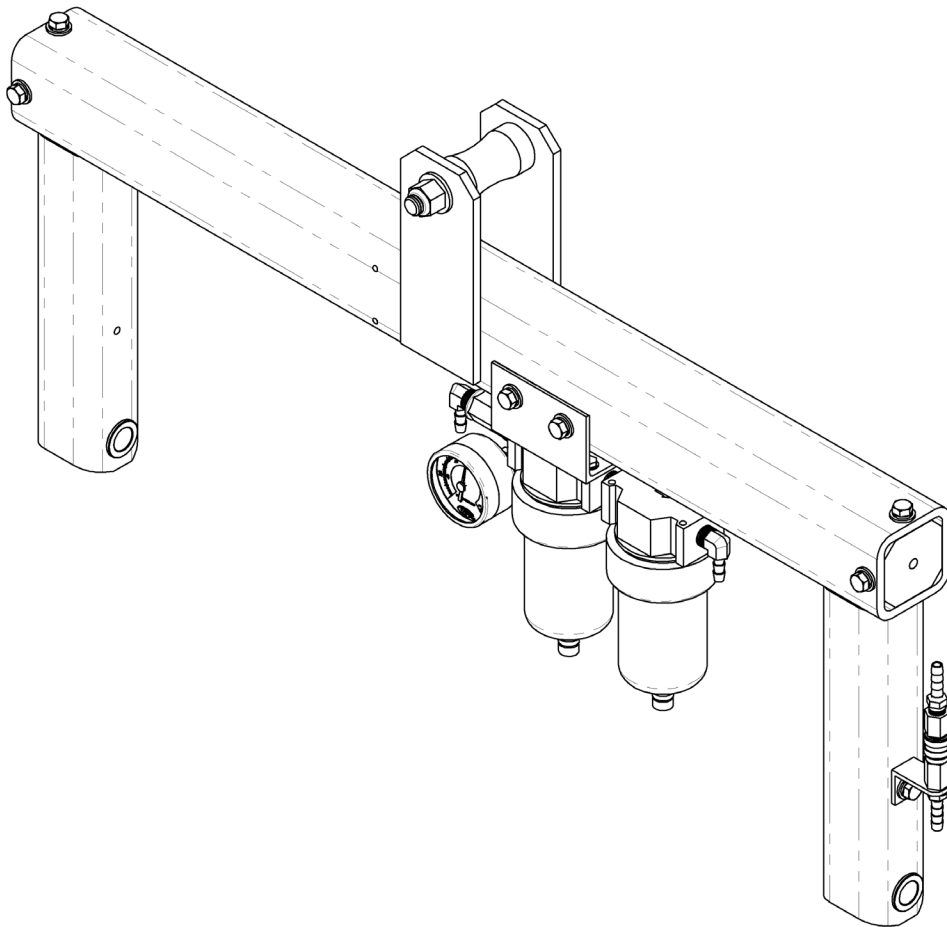

MT CENTER SPOOL LIFT BAR

Stock number: 58461AM

SPECIFICATIONS

Product Description	By eliminating the need for slings or other rigging, this option allows the hook of hoisting equipment to attach directly to the lift bar of the vacuum lifter, thereby reducing the overhead clearance requirement.
Stock Number	58461AM
Maximum Load Capacity	1500 lbs [680 kg] <i>Note: When the Maximum Load Capacity of the vacuum lifter is different, do not exceed the lesser of the two capacities (see "SPECIFICATIONS" in lifter's OPERATING INSTRUCTIONS).</i>
Weight Increase	10 lbs [5 kg] <i>Note: This weight should be added to the Lifter Weight when determining hoisting equipment capacity.</i>

Note: Before installing and using the Center Spool Lift Bar read, understand and follow the lifter's OPERATING INSTRUCTIONS. Assembly, intended use, storage, operation, inspections, tests and maintenance in the lifter's instructions should be understood to include options, when relevant. All warnings in the "SAFETY" section, as well as alerts in other sections, are applicable when using the Center Spool Lift Bar.

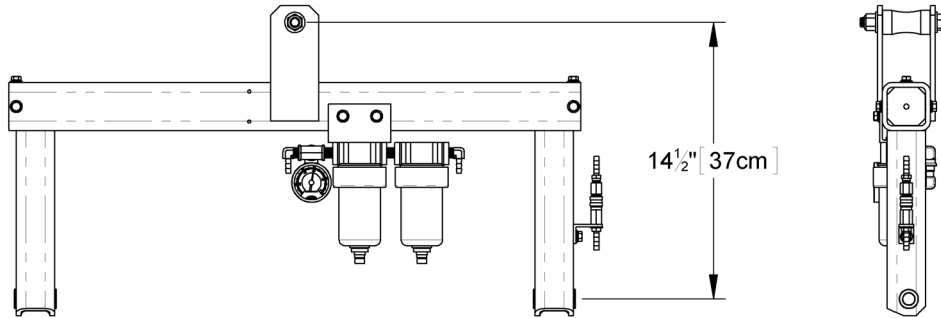

INSTALLATION

1A

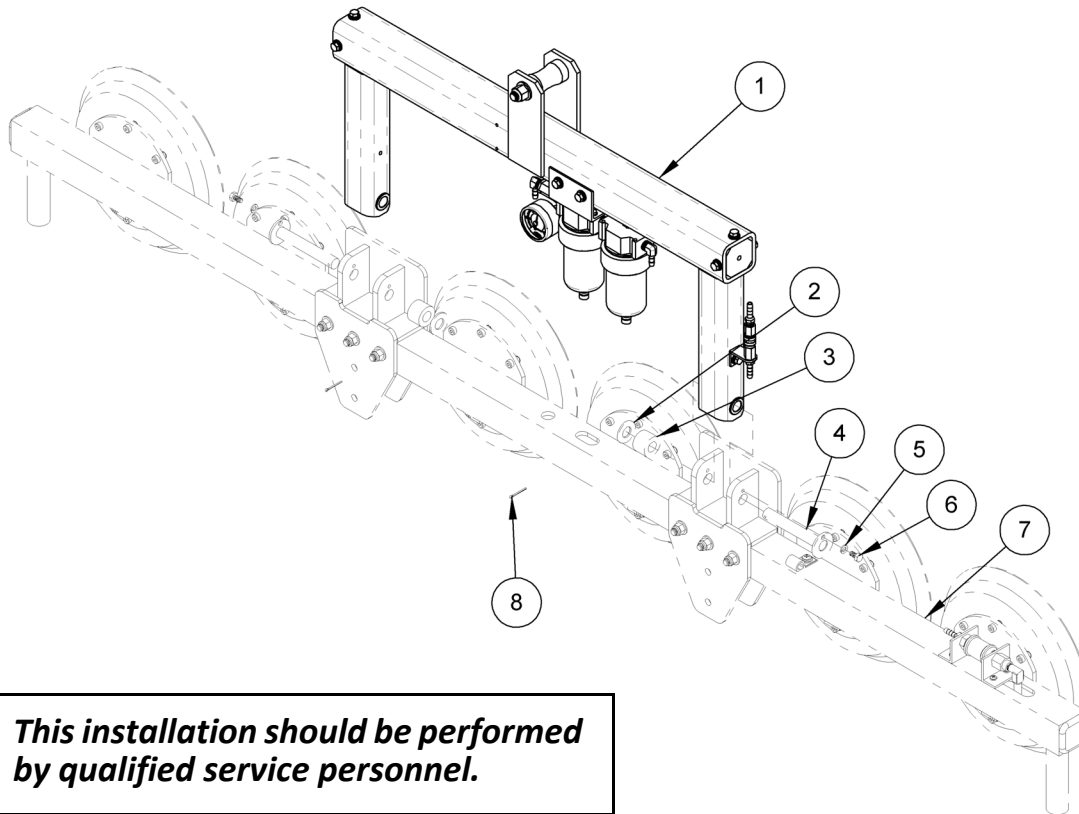

This installation should be performed by qualified service personnel.

- 1) Remove the original lift bar from the vacuum lifter as follows:
 - 1.1) Use the hoisting equipment to gently lower the lifter onto a stable support.
 - 1.2) Carefully disconnect the vacuum hoses from the air filters and lift bar (click or scan the QR code at right, to access a video demonstration).
 - 1.3) Remove and save the tilt pins (item 4 in fig. 1A) and all associated hardware (items 2, 3, 5, 6 and 8). Make sure to note their placement and order, for later reinstallation of the tilt pins.
 - 1.4) Clean hardware and replace any worn-out hardware, as necessary (see “REPLACEMENT PARTS” on page 5).



Caution: Cotter pins are a single-use item; replace them each time they are removed.

- 2) Install the Center Spool Lift Bar (item 1), making sure all hardware fits correctly. Tighten the fasteners securely. Then reconnect the vacuum hoses (click or scan QR code above).
- 3) Follow the other steps for “ASSEMBLY” of the vacuum lifter, as directed in the lifter's *OPERATING INSTRUCTIONS*, but disregard the directions about lift slings. Instead, attach the hoisting equipment hook directly to the lift point.

REPLACEMENT PARTS

Stock No.	Description	Qty.
65301	Foam Rubber Spacer (7/8" [2.2 cm] in length)	2
59022	Tilt Pin	2
13200	Cotter Pin – 3/32" x 1"	2
12752	Lock Washer – 1/4" ID – Split	2
12030	Flat Washer – 5/8" SAE	2
10702	Cap Screw – Hex Head – 120 KSI Rated	2

**SERVICE ONLY WITH IDENTICAL REPLACEMENT PARTS,
AVAILABLE AT WPG.COM OR THROUGH AN AUTHORIZED WPG DEALER**

LIMITED WARRANTY

Wood's Powr-Grip® (WPG) products are carefully constructed, thoroughly inspected at various stages of production, and individually tested. They are warranted to be free from defects in workmanship and materials for a period of one year from the date of purchase.

If a problem develops during the warranty period, follow the instructions below to obtain warranty service. If inspection shows that the problem is due to defective workmanship or materials, WPG will repair the product without charge.

Warranty does not apply when ...

- modifications have been made to the product after leaving the factory
- rubber portions have been cut or scratched during use;
- repairs are required due to abnormal wear and tear, and/or;
- the product has been damaged, misused or neglected.

If a problem is not covered under warranty, WPG will notify the customer of costs prior to repair. If the customer agrees to pay all repair costs and to receive the repaired product on a C.O.D. basis, WPG then will proceed with repairs.

To Obtain Repairs or Warranty Service

For purchases in *North America*:

Contact the WPG Technical Service Department. When factory service is required, ship the complete product – prepaid – along with your name, address and phone number to the street address listed at the bottom of this page. WPG may be reached by phone or fax numbers listed below.

For purchases in *all other localities*:

Contact your dealer or the WPG Technical Service Department for assistance. WPG may be reached by phone or fax numbers listed below.

Wood's Powr-Grip Co., Inc.

908 West Main St.

Laurel, MT 59044 USA

406-628-8231 (phone)

800-548-7341 (phone)

406-628-8354 (fax)

