

**KEEP FOR FUTURE REFERENCE**



*P.O. Box 368 – 908 West Main  
Laurel, MT USA 59044  
phone 800-548-7341  
phone 406-628-8231  
fax 406-628-8354*

# INSTRUCTIONS

International Version

STOCK NUMBER: 58461AM

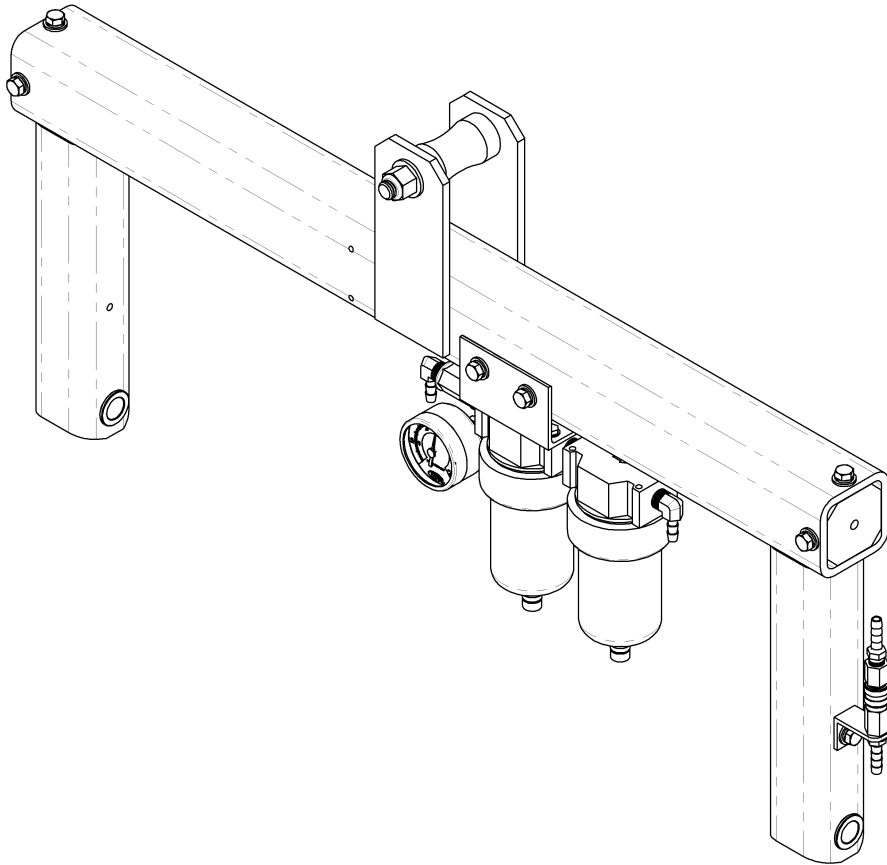

**MT CENTER SPOOL LIFT BAR**



***READ ALL INSTRUCTIONS AND WARNINGS  
BEFORE USING THIS PRODUCT***



**DESIGNED FOR THE MATERIALS HANDLING PROFESSIONAL**



# SPECIFICATIONS

---

**Stock Number:** 58461AM

**Description:** By eliminating the need for slings or other rigging, this option allows the hook of hoisting equipment to attach directly to the lift bar of the vacuum lifter, thereby reducing the overhead clearance requirement.

**Maximum Load Capacity:** 1500 lbs [680 kg]

Note: When the Maximum Load Capacity of the vacuum lifter is different, do not exceed the **lesser** of the two capacities (see SPECIFICATIONS in lifter's instruction manual).

**Weight Increase:** 10 lbs [5 kg]

Note: Make sure to add the weight of all options to the Lifter Weight when you are selecting appropriate hoisting equipment (see ASSEMBLY in lifter's instruction manual).

## WARNINGS

---



Powr-Grip is pleased to offer the most reliable materials handling products available. Despite the high degree of security provided by this product, certain precautions must be observed to protect the lifter operator and others.



**Never** use a Center Spool Lift Bar that is damaged, malfunctioning, or missing parts.

**Never** exceed the Maximum Load Capacity listed for the Center Spool Lift Bar or for the lifter, whichever is **less** (see SPECIFICATIONS in lifter's instruction manual).

**Always** make sure the Center Spool Lift Bar is installed as directed (see ASSEMBLY).

**Always** remember that modifications to the Center Spool Lift Bar may compromise its safety. Wood's Powr-Grip cannot be responsible for the safety of a Center Spool Lift Bar that has been modified by the customer. For consultation, contact Wood's Powr-Grip (see LIMITED WARRANTY).

# ASSEMBLY

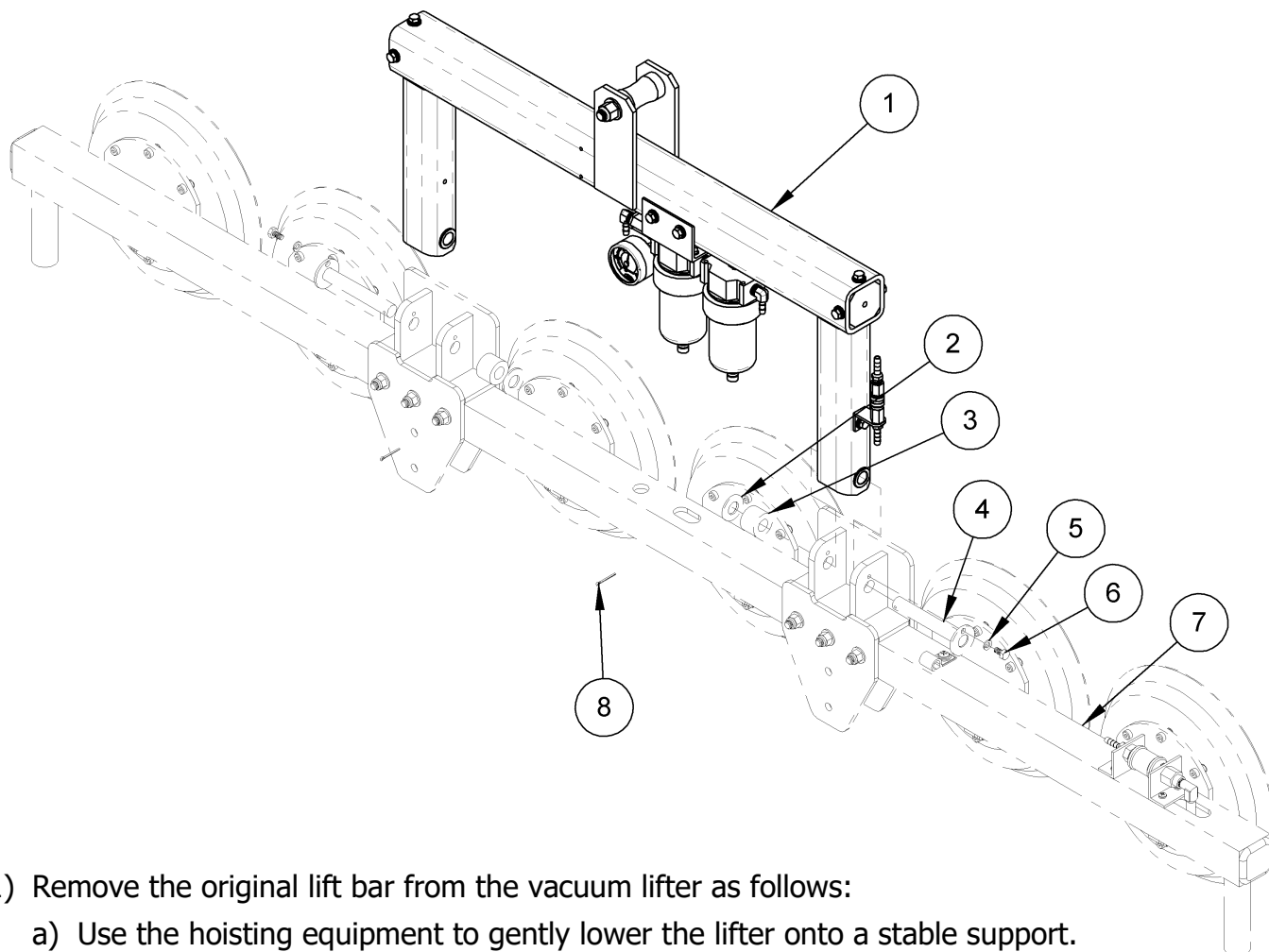

- 1) Remove the original lift bar from the vacuum lifter as follows:
  - a) Use the hoisting equipment to gently lower the lifter onto a stable support.
  - b) Carefully disconnect the vacuum hoses from the air filters and lift bar.
  - c) Remove the tilt pins (#4) and all associated hardware (#2, #3, #5, #6 and #8) as shown in the illustration. Be sure to take note of the placement and order of all hardware, so that you will know how to reinstall the tilt pins.
  - d) Save the tilt pins and hardware for use when installing the Center Spool Lift Bar. Clean hardware and replace any worn-out hardware, as necessary (see REPLACEMENT PARTS LIST).

**Caution: Cotter pins are a single-use item; replace them each time they are removed.**

- 2) Install the Center Spool Lift Bar (#1) as shown in the illustration. Make sure all hardware fits correctly, and tighten the fasteners securely. Then reconnect the vacuum hoses.
- 3) Follow the other steps for ASSEMBLY of the vacuum lifter, as directed in the lifter's instruction manual, but disregard the directions about lift slings. Instead, attach the hoisting equipment hook directly to the lift spool.
- 4) Inspect and test the Center Spool Lift Bar as directed (see MAINTENANCE).

# OPERATION

---

After the Center Spool Lift Bar has been installed, operate the lifter as directed in the OPERATION section of lifter's instruction manual.

## MAINTENANCE

---

When performing inspections and tests as directed in the lifter's instruction manual, be sure to include all parts of the Center Spool Lift Bar whenever applicable.

## REPLACEMENT PARTS LIST

---

<b>Stock No.</b>	<b>Description</b>	<b>Qty.</b>
65301	Foam Rubber Spacer (7/8" [2.2 cm] in length)	2
59022	Tilt Pin	2
13200	Cotter Pin – 3/32" x 1"	2
12752	Lock Washer – 1/4" ID – Split	2
12030	Flat Washer – 5/8" SAE	2
10702	Cap Screw – Hex Head – 120 KSI Rated	2

***SERVICE ONLY WITH IDENTICAL REPLACEMENT PARTS  
SUPPLIED BY OR APPROVED BY WOOD'S POWR-GRIP CO., INC.***

# LIMITED WARRANTY

---

Powr-Grip products are carefully constructed, thoroughly inspected at various stages of production, and individually tested. They are warranted to be free from defects in workmanship and materials for a period of one year from the date of purchase.

If a problem develops during the warranty period, follow the instructions hereafter to obtain warranty service. If inspection shows that the problem is due to defective workmanship or materials, Powr-Grip will repair the product without charge.

## **WARRANTY DOES NOT APPLY WHEN:**

Modifications have been made to the product after leaving the factory.

Rubber portions have been cut or scratched during use.

Repairs are required due to abnormal wear and tear.

The product has been damaged, misused, or neglected.

If a problem is not covered under warranty, Powr-Grip will notify the customer of costs prior to repair. If the customer agrees to pay all repair costs and to receive the repaired product on a C.O.D. basis, Powr-Grip then will proceed with repairs.

## **TO OBTAIN REPAIRS OR WARRANTY SERVICE**

For purchases in *North America*:

Contact the Technical Service Department at Wood's Powr-Grip Co. When factory service is required, ship the complete product--prepaid--along with your name, address and phone number to the street address hereafter.

For purchases in *all other localities*:

Contact your dealer or the Technical Service Department at Wood's Powr-Grip Co. for assistance.

Wood's Powr-Grip Co., Inc.  
908 West Main St. / P.O. Box 368  
Laurel, MT USA 59044

phone 800-548-7341

phone 406-628-8231

fax 406-628-83