

KEEP FOR FUTURE REFERENCE



*P.O. Box 368 – 908 West Main
Laurel, MT USA 59044
phone 800-548-7341
phone 406-628-8231
fax 406-628-8354*

INSTRUCTIONS

International Version

STOCK NUMBER: 57353



**MRTALP
VERTICAL LIFT BAR**



***READ ALL INSTRUCTIONS AND WARNINGS
BEFORE USING THIS PRODUCT***



DESIGNED FOR THE MATERIALS-HANDLING PROFESSIONAL

SPECIFICATIONS

- Stock Number:** 57353
- Description:** This option allows a Wood's Powr-Grip model MRTALP6 and MRTALP8 vacuum lifters to be used in applications that require increased capacity to lift loads in the upright orientation.
- Max. Load Capacity:** 1,400 lbs [635 kg] **Note: This capacity applies only when the lifter is oriented vertically with all 8 vacuum pads in use.**
- Weight Increase:** 18 lbs [9 kg] when Vertical Lift Bar is installed
Note: Make sure to add the weight of all options to the Lifter Weight when you are selecting appropriate hoisting equipment (see ASSEMBLY in MRTALP lifter's instruction manual).

WARNINGS



Powr-Grip is pleased to offer the most reliable materials handling products available. Despite the high degree of security provided by the Vertical Lift Bar, certain precautions must be observed to protect the operator and others.



- Never** use a Vertical Lift Bar that is damaged, malfunctioning, or missing parts.
- Never** exceed the Maximum Load Capacity listed for the Vertical Lift Bar (see SPECIFICATIONS).
- Always** be aware that Load Capacity is limited by the pad frame configuration when fewer than 8 vacuum pads are in use (see ASSEMBLY section of lifter's instruction manual for details).
- Always** install the Vertical Lift Bar in the prescribed orientation (see ASSEMBLY).
- Never** attempt to use the Vertical Lift Bar unless the load is oriented in the upright position.
- Always** remember that modifications to the Vertical Lift Bar may compromise safety. Wood's Powr-Grip cannot be responsible for the safety of a Vertical Lift Bar that has been modified by the customer. For consultation, contact Wood's Powr-Grip (see LIMITED WARRANTY).

ASSEMBLY

Consult the ASSEMBLY and INTENDED USE sections of the MRTALP lifter's instruction manual to determine which pad frame configuration is needed to support the load correctly.

⚠ WARNING: If fewer than 8 pads are used, Load Capacity is reduced.

If a configuration with fewer than 8 vacuum pads is selected, consult the lifter's instruction manual to determine the relevant Load Capacity.

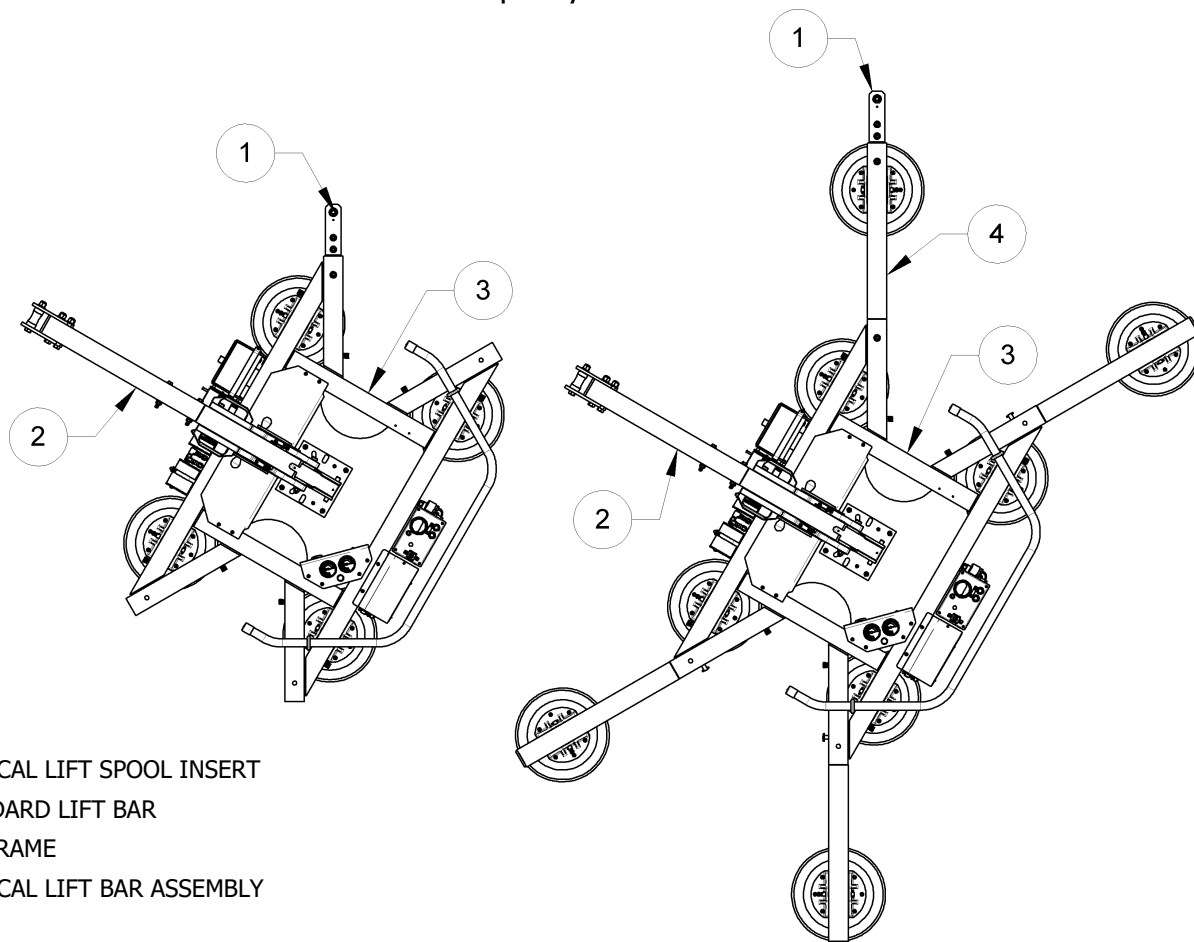

- 1 VERTICAL LIFT SPOOL INSERT
- 2 STANDARD LIFT BAR
- 3 PAD FRAME
- 4 VERTICAL LIFT BAR ASSEMBLY

MRTALP-DC shown with Vertical Lift Bar option.

Before you suspend the vacuum lifter from hoisting equipment as directed in the lifter's instruction manual, install the appropriate components of the Vertical Lift Bar (vertical lift spool insert and, when needed, vertical lift bar assembly), as shown above. Be sure to use the vertical lift bar assembly whenever it is needed to position the lift point beyond the edge of the load.

Make sure the rubber bumper faces toward the load. Then install the retaining bolts and all associated hardware, making sure to tighten the bolts securely. Finally, attach the hoisting equipment hook to the lift spool of the Vertical Lift Bar (*not* the standard lift bar).

OPERATION

Operate the vacuum lifter as directed in the OPERATION section of the MRTALP lifter's instruction manual, with the following exceptions:



WARNING: Never attempt to lift load when lifter is in horizontal orientation.

In order to use the Vertical Lift Bar, the lifter must be attached only to loads oriented in the upright position. Center the pad frame from left to right on the load, and position the uppermost vacuum pad near the top edge. This position will maximize stability while lifting the load. Make sure that all vacuum pads will fit entirely on the load's contact surface and that they will be loaded evenly while lifting. Then apply the lifter to the load so that the pads are touching the contact surface.

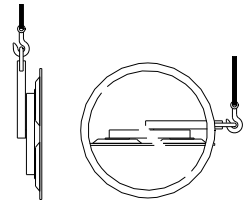

MAINTENANCE

When performing inspections and tests of the lifter as directed in the MAINTENANCE section of the MRTALP lifter's instruction manual, be sure to include all relevant parts of the Vertical Lift Bar whenever applicable.

REPLACEMENT PARTS LIST

Stock No.	Description	Qty.
49122	End Plug – 2" x 2" x 1/4" Tubing Size	1
12822	3/8" Flat Washer	2
12756	3/8" Lock Washer	2
11120	3/8-16 Hex Nut	2
10916	Shoulder Bolt – Socket Head – 1/2" x 2 1/2" x 3/8-16 Thread	2
08093	3/4" Rubber Bumper	1

***SERVICE ONLY WITH IDENTICAL REPLACEMENT PARTS,
AVAILABLE AT WPG.COM OR THROUGH AN AUTHORIZED WPG DEALER***

LIMITED WARRANTY

Powr-Grip products are carefully constructed, thoroughly inspected at various stages of production, and individually tested. They are warranted to be free from defects in workmanship and materials for a period of one year from the date of purchase.

If a problem develops during the warranty period, follow the instructions hereafter to obtain warranty service. If inspection shows that the problem is due to defective workmanship or materials, Powr-Grip will repair the product without charge.

WARRANTY DOES NOT APPLY WHEN:

Modifications have been made to the product after leaving the factory.

Rubber portions have been cut or scratched during use.

Repairs are required due to abnormal wear and tear.

The product has been damaged, misused, or neglected.

If a problem is not covered under warranty, Powr-Grip will notify the customer of costs prior to repair. If the customer agrees to pay all repair costs and to receive the repaired product on a C.O.D. basis, Powr-Grip then will proceed with repairs.

TO OBTAIN REPAIRS OR WARRANTY SERVICE

For purchases in *North America*:

Contact the Technical Service Department at Wood's Powr-Grip Co. When factory service is required, ship the complete product—prepaid—along with your name, address and phone number to the street address hereafter.

For purchases in *all other localities*:

Contact your dealer or the Technical Service Department at Wood's Powr-Grip Co. for assistance.

Wood's Powr-Grip Co., Inc.
908 West Main St. / P.O. Box 368
Laurel, MT USA 59044

phone 800-548-7341

phone 406-628-8231

fax 406-628-8354