

POWER TILTERS 500 & 600

MODELS: PT410TAIR, PT49AC & PT410CAC

Use these highly versatile vacuum lifters to handle stone and other dense materials, or to remove and install bulletproof windshields.*

90° Effortless Tilting

A tilt actuator does the hard work of moving a load from flat to upright and back again, maximizing efficiency and productivity.

Adjustable Lift Point

Changes the lifter's hang angle for more precise load positioning.

Multiple Pad Frame Configurations

Looking to get a grip on curved surfaces? Need to adjust the pad spread for wider or narrower loads? WPG has the choices you need to match the job.

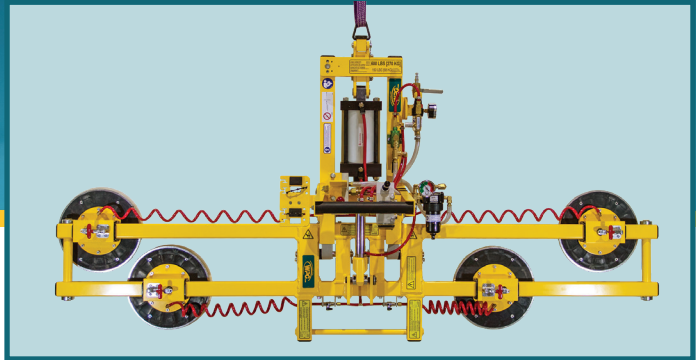

PT410TAIR

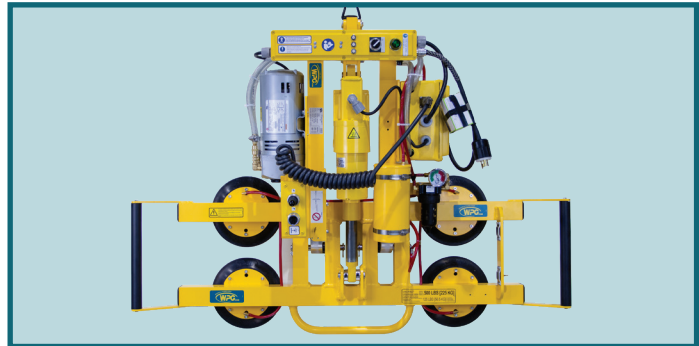

PT49AC

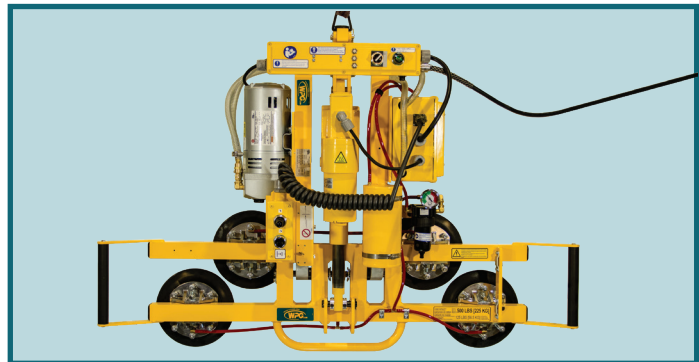

PT410CAC

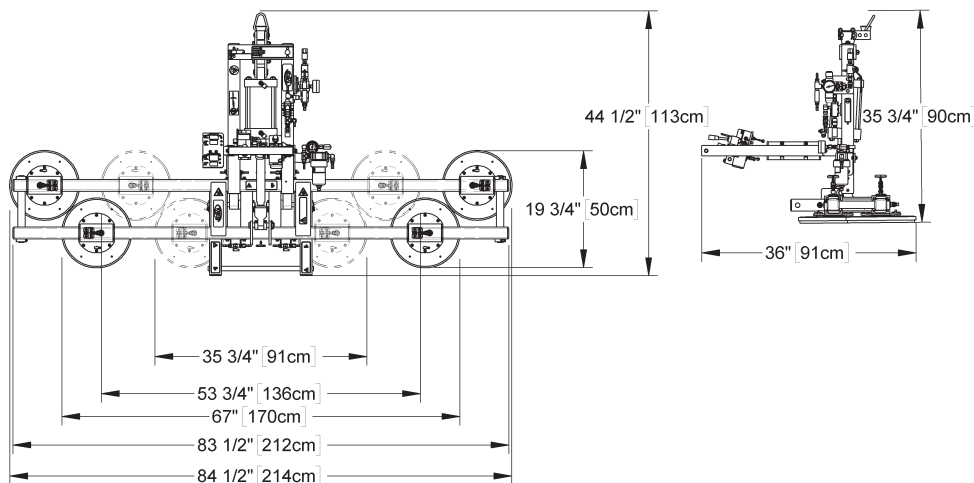

PT410TAIR (97090) WITH STANDARD PAD FRAME

* Thickness of windshield glass will vary based on a vehicle's make and model. PT410CAC and the Alternative Pad Frame are designed for bulletproof windshields and not intended for use on glass less than 0.25" (7 mm) thick. PT410TAIR is not intended for use on any windshield. For normal-sized windshields, a SOLO NEO windshield setting kit from aegistools.com is recommended

Model	PT410TAIR (97090)	PT49AC (97095)	PT410CAC (97075)
Maximum Load Capacity	600 lbs [270 kg]	500 lbs [225 kg]	500 lbs [225 kg]
Standard Pad Spread	Minimum Length: 53-3/4" [137 cm] Maximum Length: 84-1/2" [215 cm] Width: 19-3/4" [50 cm]	20-1/2" x 37-1/2" [52 cm x 96 cm]	17" x 45-1/2" [43 cm x 116 cm]
Number/Size of Pads	4 / 10" [25 cm] diameter with replaceable sealing rings	4 / 9" [23 cm] diameter	4 / 10" [25 cm] diameter concave
Lifter Weight	150 lbs [68 kg]	165 lbs [75 kg]	165 lbs [75 kg]
Standard Operating Power	Compressed Air, 8SCFM [226 liters/minute] @ 80 psi [550 kPa]	120 volts AC, 60 hertz, 10 amps	120 volts AC, 60 hertz, 10 amps
Attach/ Release	6 seconds/3 seconds (approx.)	10 seconds/6 seconds (approx.)	10 seconds/6 seconds (approx.)
Time to Achieve 90° Tilt	8 seconds (approximately)	7 seconds (approximately)	7 seconds (approximately)
Tilt Duty	Continuous	81 tilts per hour	81 tilts per hour

Load Movement Power tilt, 90° between upright and flat

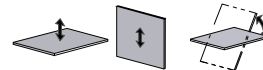

STANDARD FEATURES

97090 97095 97075

Multi-Position Lift Shackle

Provides four different lift points to optimize the lifter's hang angle, making repetitive material placement quicker and easier

✓ ✓ ✓

Movable Control Pendant

Enables operator to control lifter functions at a safe distance from loads in motion

✓ ✓

Green Lift Light

Provides visual assurance to know when vacuum is sufficient for lifting

✓ ✓

Vacuum Gauge

Features green and red zones to clearly indicate whether vacuum levels are sufficient for lifting

✓ ✓ ✓

Vacuum Line Filter

Protects the vacuum generating system from contaminants

✓ ✓ ✓

Vacuum Reserve Tank

Reduces attachment time and extends time for supporting loads during a power outage

✓ ✓ ✓

Spring-Mounted Vacuum Pads

Automatically adjust to match the angle of load surfaces, easing attachment

✓ ✓ ✓

Sliding Adjustable Pad Mounts

Accommodate various load sizes by sliding to different locations on the pad frame, with infinitely variable positioning

✓

Twist-Lock Electrical Plug

Provides a secure connection to the AC power source, to prevent accidental disconnection

✓ ✓

Blow-Off Release

Reverses airflow to quickly release loads without after-stick

✓ ✓ ✓

AVAILABLE OPTIONS

Vacuum Loss Warning Buzzer (93780BM)

Uses advanced logic circuitry to monitor vacuum level and sound an alarm only when insufficient vacuum could be hazardous

✓ ✓ ✓

Individual Pad Shutoffs (93011)

Enable lifter to handle various load sizes and shapes by shutting off airflow from specific vacuum pads (standard on Sliding Adjustable Pad Frame and Curved Surface Adjustable Pad Frame)

✓ ✓ ✓

AVAILABLE OPTIONS

97090 97095 97075

Voltage Adaptation (93032 & 93032AM)

Enables lifters to operate using AC voltages best suited to specific uses and geographical areas

✓ ✓

Alternative Pad Compounds

Specially designed for heat resistance, marking resistance, coated surfaces and other purposes

✓ ✓ ✓

Alternative Pad Frame

Enables lifter to handle curved loads (reference illustration below)

✓ ✓

Custom Pad Frame Sizes and Capacities

Accommodate customers' specific load weight and dimension requirements

✓ ✓ ✓

DESIGN STANDARDS

ASME B30.20 (BTH-1 Design Category "B", Service Class "0"): Industry standards established by the American Society of Mechanical Engineers (ASME) and published by the American National Standards Institute (ANSI)

STANDARD PAD FRAMES

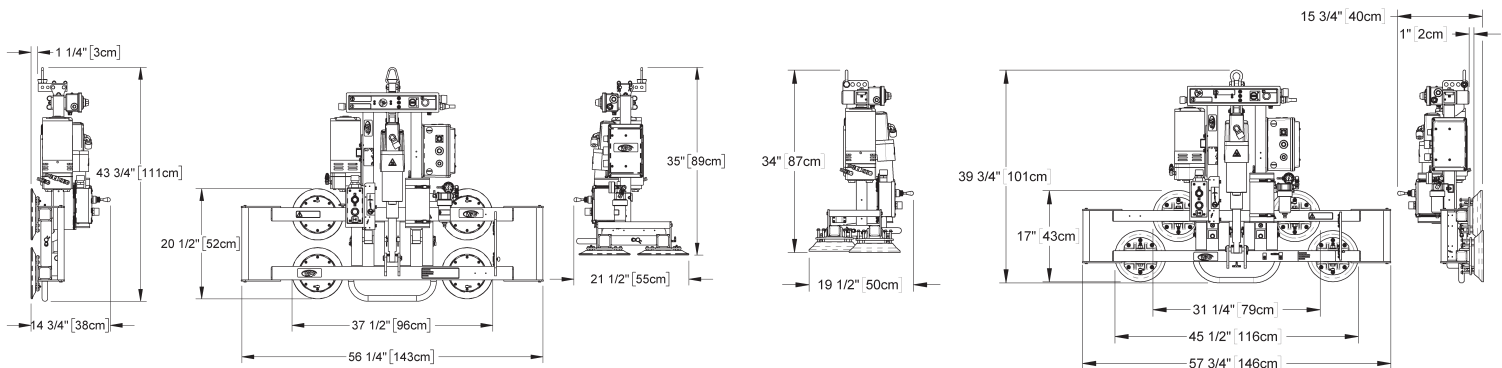

PT49AC (97095) WITH STANDARD PAD FRAME

PT410CAC (97075) WITH STANDARD PAD FRAME

ALTERNATIVE PAD FRAME

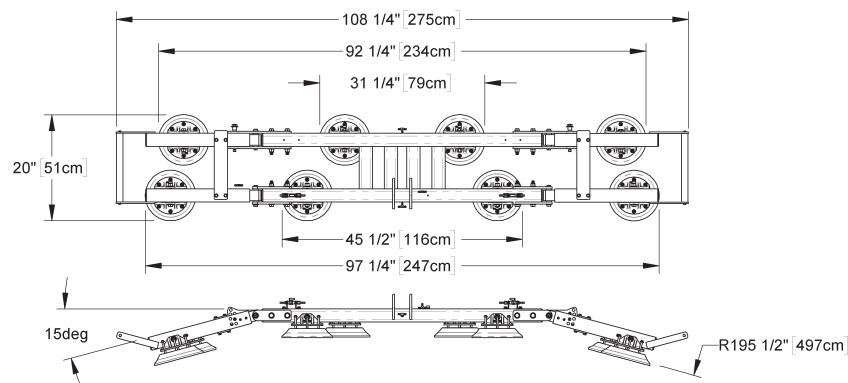

CURVED SURFACE ADJUSTABLE PAD FRAME (SPECIAL ORDER)

